

Printing

Using color

Paper handling

Maintenance

Troubleshooting

Administration

Index

The print quality and feed reliability of your printer and options can vary with the type and size of print media you use. This section provides guidelines for each type of print media. For information on card stock and labels, refer to the *Card Stock & Label Guide* located on the Lexmark Web site at www.lexmark.com.

Always print samples on the print media you are considering before buying large quantities.

Click a topic for more information:

- Paper characteristics
- Recommended paper
- Unsatisfactory paper
- Choosing preprinted forms and letterhead
- Choosing paper
- Choosing envelopes
- Choosing labels
- Choosing card stock
- Choosing transparencies



Printing

Using color

Paper handling

Maintenance

Troubleshooting

Administration

Index

Paper characteristics

The following paper characteristics affect print quality and reliability. Keep these guidelines in mind when evaluating new paper stock.

Weight

The printer can feed paper weights from 60 to 163 g/m² (16 to 43 lb bond) grain long. Paper lighter than 60 g/m² (16 lb) might not be stiff enough to feed properly, causing paper jams. For best performance, use 90 g/m² (24 lb) Hammermill Laser Print paper. To use paper narrower than 182 x 257 mm (7.2 x 10.1 in.), we recommend the weight be greater than or equal to 90 g/m² (24 lb bond).

Curl

Curl is the tendency of paper to curve at its edges. Excessive curl can cause paper feeding problems. Curl usually occurs after the paper passes through the printer fuser, where it is exposed to high temperatures. Excessively high toner coverage, humid conditions, and paper types can contribute to paper curling.



Printing

Using color

Paper handling

Maintenance

Troubleshooting

Administration

Index

Smoothness

The degree of smoothness of paper directly affects print quality. If the paper is too rough, the toner does not fuse to the paper properly, resulting in poor print quality. If the paper is too smooth, it can cause paper feeding problems.

Moisture content

The amount of moisture in the paper affects both print quality and the ability of the printer to feed the paper properly. Leave the paper in its original wrapper until you are ready to use it. This limits the exposure of the paper to moisture changes that can degrade its performance.

Fiber content

Most high-quality xerographic paper is made from 100% chemically pulped wood. This content provides the paper with a high degree of stability resulting in fewer paper feeding problems and better print quality. Paper containing fibers such as cotton possess characteristics that can result in degraded paper handling.



Printing

Using color

Paper handling

Maintenance

Troubleshooting

Administration

Index

Recommended paper

To ensure the best print quality and feed reliability, use 90 g/m² (24 lb) Hammermill Laser Print paper. Business papers designed for general business use may also provide acceptable print quality.

Always print several samples before buying large quantities of any type of paper. When choosing any papers, consider the weight, fiber content, and color of the paper.

The laser printing process heats paper to high temperatures of 165°C (329°F). Use only papers that are able to withstand these temperatures without discoloring, bleeding, or releasing hazardous emissions. Check with the manufacturer or vendor to determine whether the paper you've chosen is acceptable for laser printers.

Unsatisfactory paper

The following papers are not recommended for use with the printer:

- Chemically treated papers used to make copies without carbon paper, also known as carbonless papers, carbonless copy paper (CCP), or no carbon required (NCR) paper
- Coated papers (erasable bond)
- Multiple-part forms or documents



Printing

Using color

Paper handling

Maintenance

Troubleshooting

Administration

Index

- Preprinted papers that require a *registration* (the precise print location on the page) greater than ± 0.09 in., such as optical character recognition (OCR) forms

In some cases, you can adjust registration with your software application to successfully print on these forms.

- Preprinted papers with chemicals that may contaminate the printer
- Preprinted papers that can be affected by the temperature in the printer fuser
- Rough-edged or curled papers
- Synthetic papers
- Thermal papers
- Less than 60 g/m² (16 lb) recycled paper
- Recycled papers containing more than 25% post-consumer waste that do not meet DIN 19 309

Choosing preprinted forms and letterhead

Use the following guidelines when selecting preprinted forms and letterhead paper:

- Use only forms and letterhead printed using an offset lithographic or engraved printing process.



Printing

Using color

Paper handling

Maintenance

Troubleshooting

Administration

Index

- Choose papers that absorb ink, but do not bleed.
- Avoid papers with rough or heavily textured surfaces.

Use papers printed with heat-resistant inks designed for use in xerographic copiers. The ink must withstand temperatures of 165°C (329°F) without melting or releasing hazardous emissions. Use inks that are not affected by the resin in the toner. Inks that are oxidation-set or oil-based should meet these requirements. Latex inks might not meet these requirements. If you are in doubt, contact your paper supplier.

Choosing paper

Proper paper loading helps prevent paper jams and ensure trouble-free printing.

To help avoid jams or poor print quality:

- *Always* use new, undamaged paper.
- Before loading paper, know the recommended print side of the paper you're using. This information is usually indicated on the paper package.
- *Do not* use paper that you have cut or trimmed yourself.
- *Do not* mix paper sizes, weights, or types in the same paper source; mixing results in jams.
- *Do not* use coated papers.



Printing

Using color

Paper handling

Maintenance

Troubleshooting

Administration

Index

- *Do not* remove trays while a job is printing or **Busy** is displayed on the operator panel.
- Make sure the Paper Type, Paper Texture, and Paper Weight settings are correct. (See **Paper Menu** for detailed information about these settings.)
- Make sure the paper is properly loaded in the paper source.
- Flex paper back and forth. Do not fold or crease the paper. Straighten the edges on a level surface.

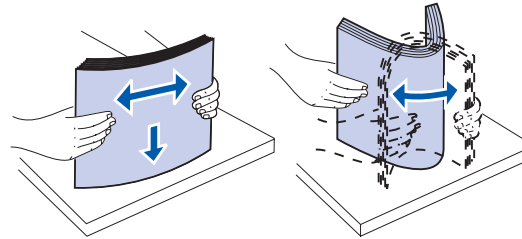

Choosing envelopes

When printing on envelopes:

- To achieve the best possible print quality, use only high-quality envelopes that are designed for use in laser printers.
- Use only new, undamaged envelopes.



Printing

Using color

Paper handling

Maintenance

Troubleshooting

Administration

Index

- Load only one size of envelope at a time in the multipurpose feeder.
- Make sure the glue is not exposed.
- Do not use envelopes that contain moisture or high humidity.

Moist envelopes or envelopes containing high humidity (over 60%) may become sealed from the high fuser temperature.

- Be sure to select MP Feeder as the paper source in the **Paper Menu** and set the correct envelope size.

The laser printing process heats envelopes to a temperature of 165°C (329°F). Use only envelopes that are able to withstand these temperatures without sealing, excessive curling, wrinkling, or releasing hazardous emissions. If you have any doubts about the envelopes you are considering using, check with the envelope supplier.

For best performance, use envelopes made from 75 g/m² (20 lb bond) paper. You can use up to 105 g/m² (28 lb bond) weight for the multipurpose feeder as long as the cotton content is 25% or less. Envelopes with 100% cotton content must not exceed 90 g/m² (24 lb bond) weight.

Do *not* use envelopes that:

- Have excessive curl or twist
- Are stuck together or damaged in any way
- Contain windows, holes, perforations, cutouts, or embossing



Printing

Using color

Paper handling

Maintenance

Troubleshooting

Administration

Index

- Use metal clasps, string ties, or metal folding bars
- Have an interlocking design
- Have postage stamps attached
- Have any exposed adhesive when the flap is in the sealed or closed position
- Have nicked edges or bent corners
- Have rough, cockle, or laid finishes

Choosing labels

The printer can print on many labels designed for use with laser printers. These labels are supplied in letter size and A4 size sheets.

When printing on labels:

- Be sure to select Labels in the Paper Type menu item in the Paper Menu. (See **Paper Type** for detailed information about these settings.)
- *Do not* load labels together with paper or transparencies in the same paper tray; mixing print media can cause feeding problems.
- *Do not* load partial sheets with areas exposed by missing labels; this can cause labels to peel off during printing, jam, and contaminate your printer and your toner cartridge with adhesive. It can also void your printer and cartridge warranties.



Printing

Using color

Paper handling

Maintenance

Troubleshooting

Administration

Index

- Avoid using labels that may release hazardous emissions when heated.

Note: Labels are one of the most difficult print media for laser printers. Your printer requires a special fuser cleaner for label applications in order to optimize feed reliability.

For detailed information on label printing, characteristics, and design, refer to the *Card Stock & Label Guide*, available on Lexmark Web site at www.lexmark.com.

Choosing card stock

Card stock is single-ply and has a large array of properties. The orientation of paper fibers, moisture content, thickness, and texture can all affect printing on card stock.

When printing on card stock:

- Be sure to select Card Stock in the Paper Type menu item in the Paper Menu. (See **Paper Type** for detailed information about these settings.)
- Be aware that preprinting, perforation, and creasing can significantly affect the print quality and cause paper handling or jamming problems.
- Avoid using card stock that may release hazardous emissions when heated.



Printing

Using color

Paper handling

Maintenance

Troubleshooting

Administration

Index

For more information, refer to the *Card Stock & Label Guide*, available on the Lexmark Web site at www.lexmark.com.

Choosing transparencies

The printer can print directly on transparencies designed for use in laser printers. Print quality and durability depend on the transparency used. Always print samples on the transparencies you are considering before buying large quantities.

To ensure high quality output on transparencies, we recommend using the following Lexmark transparencies. They have been designed specifically for your printer:

P/N 12A5940 (letter size)

P/N 12A5941 (A4 size)

The Paper Type setting should be set to Transparency to help prevent jams. (See **Paper Type** for detailed information about this setting.) Check with the manufacturer or vendor to determine whether your transparencies are compatible with laser printers that heat transparencies to 212°C (414°F). Use only transparencies that are able to withstand these temperatures without melting, discoloring, offsetting, or releasing hazardous emissions. For detailed information, refer to the *Card Stock & Label Guide*, which is available on the Lexmark Web site at www.lexmark.com.



Printing

Using color

Paper handling

Maintenance

Troubleshooting

Administration

Index

Note: Transparencies cannot be fed from trays other than the optional heavy media tray and the multipurpose feeder.

Be careful when you handle transparencies. Fingerprints on the surface of the transparency cause poor print quality. ▲

