



Lexmark CS943de

Large-format colour printing flexibility



Lexmark CS943de

The Lexmark CS943de colour printer is designed for security, usability and reliability for large workgroups at speeds up to 55 pages per minute*. The simplified, intuitive 10.9 cm touchscreen makes handling your print jobs easy.

Flexible input and output

- ▶ Print large-format paper sizes slightly larger than SRA3+ (up to 329 x 483 mm).
- ▶ Standard input capacity is 1,140 pages; optional additional trays expand paper input capacity up to 5,140 pages.
- ▶ Several finishing options are available: staple finisher, staple hole punch finisher, booklet finisher or Lexmark's first trifold/Z-fold finisher.

Secure by design

- ▶ Lexmark security features help keep your information safe - in the document, on the device, over the network and at all points in between.
- ▶ Always improving security, we now include a standard Trusted Platform Module**, which delivers authentication, system integrity checks, and cryptographic capabilities to create a unique digital system fingerprint.

Enhance professional image with brilliant colour for large-format printing

- ▶ Enjoy vibrant colour with standard advanced features like PANTONE® calibration and Lexmark Named Colour

Replacement for consistent branding and professional appearance.

- ▶ Replacement cartridges yield up to 52,000/26,000 black/colour pages***.

Always focused on sustainability

- ▶ CS943de is designed for the circular economy.
- ▶ Automatic two-sided printing is standard, along with built-in energy-saving modes that help support ratings of EPEAT® Silver and ENERGY STAR® certified.

Power up with IoT

- ▶ Our sophisticated, IoT-enabled printers are loaded with sensors that continuously monitor hundreds of data points.
- ▶ When you connect your device to Lexmark Cloud Services, you can optimise performance and uptime with additional features like predictive service and automatic supplies replenishment.

This is a Class A device according to international electromagnetic emissions standards (i.e. FCC Rules, EN 55022/EN 55032, etc.). Class A products are intended for use in non-residential/non-domestic environments. Use of a Class A product in residential/domestic environments may cause interference to radio communications and require corrective measures.

* Print speeds measured in accordance with ISO/IEC 24734 (ESAT). For more information see: www.lexmark.com/ISOspeeds.

** The Trusted Platform Module (TPM) is not available in some countries.

*** Average continuous black or continuous composite colour (CMY) declared yield in one-sided (simplex) mode up to this number of pages in accordance with ISO/IEC 19798. Actual yield will vary considerably based upon many factors. See www.lexmark.com/yields for more information.

Lexmark CS943de

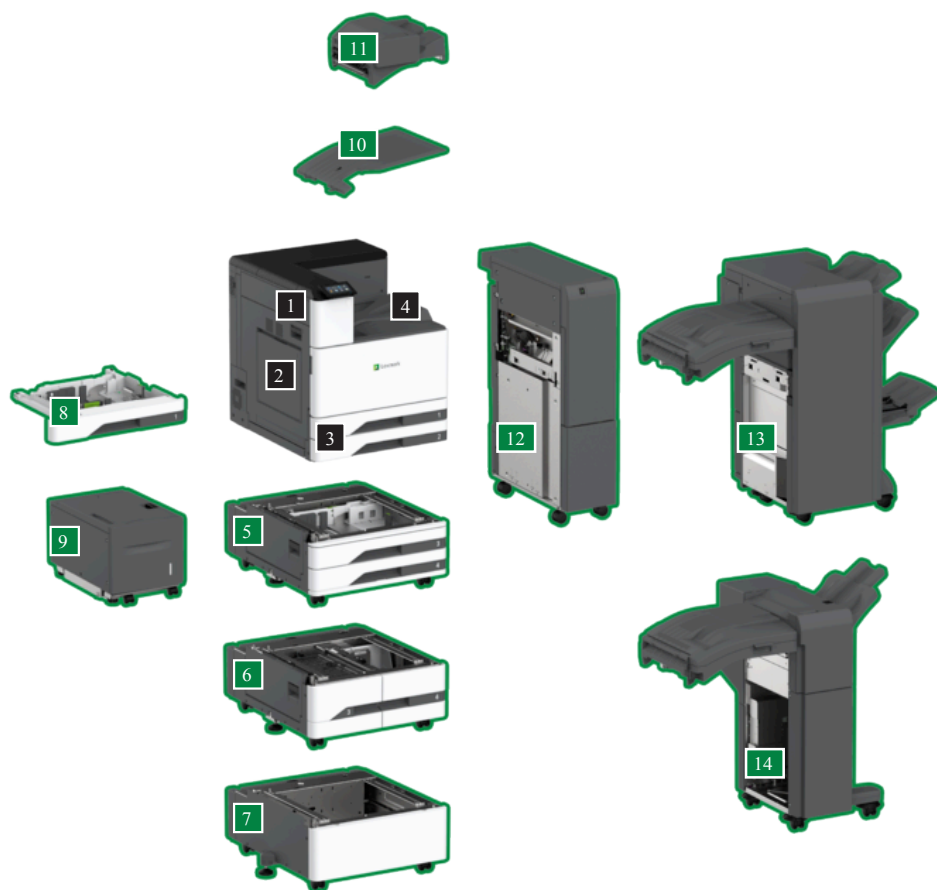

- 1 **Printer with 10.9 cm touch screen**
714 x 620 x 743 mm
- 2 **100-Sheet multipurpose feeder**
Dimensions included as part of base model
- 3 **2 x 520-Sheet tray**
Dimensions included as part of base model
- 4 **400-Sheet output bin**
Dimensions included as part of base model
- 5 **2 x 520-Sheet Tray**
305.2 x 668.5 x 720 mm
- 6 **2000-Sheet Tandem Tray with Caster**
305.2 x 668.5 720 mm
- 7 **Caster Spacer**
305 x 669 x 720 mm
- 8 **Envelope Tray**
89.9 x 619.9 x 565.5 mm
- 9 **2000-Sheet Tray**
491 x 751 x 526 mm

- 10 **Dual Catch Bin**
125 x 474 x 380 mm
- 11 **500-Sheet Staple Offset Finisher**
238 x 478 x 460.5 mm
- 12 **Zfold Trifold option for Booklet Finisher**
991 x 232 x 726 mm
- 13 **Booklet Staple (2/3) Hole Punch Finisher**
1056 x 790 x 589 mm
- 14 **2000-Sheet Staple 2/3 Hole Punch Finisher**
983 x 962 x 653 mm



P/N	Hardware
32D0014	Lexmark CS943de
P/N	Supplies
73D0HC0	Lexmark CS943 Cyan 26K Toner Cartridge
73D0HK0	Lexmark CS943 Black 52K Toner Cartridge
73D0HM0	Lexmark CS943 Magenta 26K Toner Cartridge
73D0HY0	Lexmark CS943 Yellow 26K Toner Cartridge
73D0P00	Lexmark CS943, CX942, 943, 944, XC9445, 55, 65 Black 165K Photoconductor
73D0Q00	Lexmark CS943, CX942, 943, 944, XC9445, 55, 65 3-Pack 165K Photoconductor Kit
73D0W00	Lexmark CS943, CX942, 943, 944, XC9445, 55, 65 35K Waste Container
P/N	Paper Handling
32D0810	CS94x/CX94x Caster Spacer
32D0811	CS94x/CX94x 2 x 520-Sheet Tray
32D0812	CS94x/CX94x 2000-Sheet Tandem Tray with Caster
32D0813	CS94x/CX94x Envelope Tray
32D0816	CX93x/MX93x/CS94x/CX94x 2000-Sheet Tray
32D0819	CS94x/CX94x Dual Catch Bin
32D0820	CX93x/MX93x/CS94x/CX94x 500-Sheet Staple Offset Finisher
32D0823	CS94x/CX94x 2000-Sheet Staple 2/3 Hole Punch Finisher
32D0824	CS94x/CX94x 2000-Sheet Staple 2/4 Hole Punch Finisher
32D0825	Booklet Staple (2/3) Hole Punch Finisher
32D0826	CS94x/CX94x 1500-Sheet Booklet Staple 2/4 Hole Punch Finisher
32D0840	CS94x/CX94x Zfold Trifold option for Booklet Finisher
P/N	Memory Options
27X0400	500+ GB Hard Disk
57X9528	Intelligent Storage Device (ISD)
P/N	Application Solutions
57X0300	Contact Authentication Device
57X0301	Contactless Authentication Device
82S1203	IPDS License
82S1204	Bar Code License
P/N	Connectivity
1021294	USB (2 Meter) Cable
14F0100	RS-232C Serial Interface Card
27X0142	Lexmark MarkNet™ N8230 Fiber Ethernet Print Server
27X6410	Lexmark MarkNet N8372 802.11 a/b/g/n/ac Wireless Print Server
57X7040	English Keyboard Kit
SPD0002	Surge Protective Device, 220-240V

You can install one of the following: the Dual Catch Bin or the Inline Staple Finisher or the Staple Hole Punch Finisher or the Booklet Staple Hole Punch Finisher.

To install the Tri-Fold/Z-Fold Finisher, you must also install the Booklet Staple Hole Punch Finisher.

To install the Staple Hole Punch Finisher or Booklet Staple Hole Punch Finisher, you must also install the 2x520-Sheet Tray with Casters, the 2,000-Sheet Tandem Tray with Casters, or the Caster Spacer.

To install the 2,000-Sheet Tray (sidecar), you must also install the 2x520-Sheet Tray with Casters or the 2,000-Sheet Tandem Tray with Casters. It will not work with the Caster Spacer.

To install the Envelope Tray, you must remove Tray 1 and replace it with the Envelope Tray.

Product Specifications		Lexmark CS943de
Printing		
Display	Lexmark e-Task 10.9 cm colour touch screen with audible feedback	
Print Speed	Up to: Black: 55 ppm ¹ (A4) / Colour: 55 ppm ¹ (A4)	
Time to First Page	as fast as: Black: 4.9 seconds / Colour: 4.9 seconds	
Print Resolution	Black: 1200 x 1200 dpi, 2400 IQ (2400 x 600 dpi) / Colour: 1200 x 1200 dpi, 2400 IQ (2400 x 600 dpi)	
Memory	Standard: 4096 MB / Maximum: 4096 MB	
Hard Disk	Intelligent Storage Drive (optional); Magnetic Hard Disk (optional)	
Recommended Monthly Page Volume	7,000 - 50,000 pages ²	
Maximum Monthly Duty Cycle	Up to: 270 000 pages per month ³	
Supplies ⁴		
Laser Cartridge Yields	up to: 26,000 ⁵ -page Colour (CMY) Cartridges / up to: 52,000 ⁵ -page Black Cartridge	
Cartridge(s) Shipping with Product	18,500 ⁵ -page Black Toner Cartridge ⁵ , 11,500 ⁵ -page Color (CMY) Toner Cartridges ⁵	
Paper Handling		
Included Paper Handling	100-Sheet Multipurpose Feeder, 2 x 520-Sheet Tray, 400-Sheet Output Bin	
Optional Paper Handling	Booklet staple hole punch finisher, Inline Stapler, Dual Catch Bin, Envelope Tray, 2 x 520-Sheet Tray/Caster, Caster spacer, Tri-fold/Z-fold booklet finisher, Staple Punch Finisher, 2000-Sheet Tray, 2000-Sheet Tandem Tray/Caster	
Paper Input Capacity	Up to: Standard: 1140 pages 75 gsm bond / Maximum: 5140 pages 75 gsm bond	
Paper Output Capacity	Up to: Standard: 400 pages 75 gsm bond / Maximum: 2000 pages 75 gsm bond	
Media Types Supported	Labels, Card Stock, Plain Paper, Envelopes, Glossy paper, Refer to the Paper & Specialty Media Guide	
Media Sizes Supported	A6, Oficio, 7 3/4 Envelope, JIS-B4, 9 Envelope, B5, JIS-B5, A3, Ledger, A4, Legal, SRA3, A5, Hagaki Card, Letter, B5 Envelope, C4 Envelope, Statement, C5 Envelope, Executive, DL Envelope, Folio, 10 Envelope	
General Information		
Standard Ports	Gigabit Ethernet (10/100/1000), Front USB 2.0 Specification Hi-Speed Certified port (Type A), Rear USB 2.0 Specification Hi-Speed Certified port (Type A), USB 2.0 Specification Hi-Speed Certified (Type B)	
Optional Network Ports / Optional Local Ports	MarkNet N8230 Fiber Ethernet Print Server, Marknet N8372 WiFi Option / Internal RS-232C serial	
Noise Level	Operating: 50 dBA (Print)	
Specified Operating Environment	Humidity: 8 to 80% Relative Humidity / Altitude: 0 - 2500 metres / Temperature: 10 to 32°C (50 to 90°F)	
Product Warranty	1-Year Onsite Repair, Next Business Day	
Size / Weight	H x W x D: 714 x 620 x 743 mm / 82.5 kg	
ENERGY STAR Typical Electricity Consumption	TEC: 0.86 kilowatt-hours per week	

All information is subject to change without notice. Lexmark is not liable for any errors or omissions.

¹ Print and copy speeds measured in accordance with ISO/IEC 24734 and ISO/IEC 24735 respectively (ESAT). For more information see: www.lexmark.com/ISOspeeds.

² "Recommended Monthly Page Volume" is a range of pages that helps customers evaluate Lexmark's product offerings based on the average number of pages customers plan to print on the device each month. Lexmark recommends that the number of pages per month be within the stated range for optimum device performance, based on factors including: supplies replacement intervals, paper loading intervals, speed, and typical customer usage. ³ "Maximum Monthly Duty Cycle" is defined as the maximum number of pages a device could deliver in a month using a multishift operation. This metric provides a comparison of robustness in relation to other Lexmark printers and MFPs. ⁴ Product functions only with replacement cartridges designed for use in a specific geographical region. See www.lexmark.com/regions for more details. ⁵ Average continuous cartridge yield is stated number of standard pages as listed. Declared yield value in accordance with ISO/IEC 19798.

This is a Class A device according to international electromagnetic emissions standards (i.e. FCC Rules, EN 55022/EN 55032, etc.). Class A products are intended for use in non-residential/non-domestic environments. Use of a Class A product in residential/domestic environments may cause interference to radio communications and require corrective measures.

© 2022 Lexmark. All rights reserved.

Lexmark and the Lexmark logo are trademarks of Lexmark International, Inc., registered in the United States and/or other countries.

Apple and AirPrint are trademarks of Apple Inc., registered in the U.S. and other countries and regions. MOPRIA®, the Mopria® Logo, and the Mopria Alliance™ word mark and logo are registered and/or unregistered trademarks and service marks of Mopria Alliance, Inc. in the United States and other countries. Unauthorised use is strictly prohibited. ENERGY STAR and the ENERGY STAR mark are registered trademarks owned by the U.S. Environmental Protection Agency. EPEAT is a trademark of the Green Electronics Council in the United States and other countries. PANTONE® is the property of Pantone LLC. All other trademarks are the property of their respective owners.

This product includes software developed by the OpenSSL Project for use in the Open SSL Toolkit (<http://www.openssl.org/>).

