



---

## Lexmark CX943adxse

Powerful, large-format addition to your printer fleet

---



# Lexmark CX943adxse

The Lexmark CX943adxse large-format colour multifunction is designed for security, versatility and performance for large workgroups at speeds up to 55 pages per minute\*. Loaded with standard features, this model includes a 25 cm touchscreen, single-pass two-sided scanning with ultrasonic multi-feed detection and Optical Character Recognition (OCR).



## Productivity is in the box

- ▶ Maximise productivity with workflow solutions like Scan Centre for simple document routing and single-pass two-sided scanning with ultrasonic multi-feed detection for fast and reliable scanning.
- ▶ The Intelligent Storage Drive (ISD) provides solid state storage with activation-ready preloaded add-on solutions.
- ▶ A large, button-free touchscreen helps users intuitively complete every task, from the basic to the complex.

## Flexible input and output

- ▶ Print and scan large-format paper sizes slightly larger than SRA3+ (up to 329 x 483 mm).
- ▶ Standard input capacity is 3,140 pages; optional trays expand paper input capacity up to 5,140 pages.
- ▶ Several finishing options are available: staple finisher, staple hole punch finisher, booklet finisher or Lexmark's first trifold/Z-fold finisher.

## Professional colour for large-format printing

- ▶ Enjoy vibrant colour with standard advanced features like PANTONE® calibration and Lexmark Named Colour

Replacement for consistent branding and professional appearance.

- ▶ Replacement cartridges yield up to 45,000/22,000 black/colour pages\*\*.

## Secure by design

- ▶ Lexmark security features help keep your information safe - in the document, on the device, over the network and at all points in between.
- ▶ Always improving security, we now include a standard Trusted Platform Module\*\*\*, which delivers authentication, system integrity checks, and cryptographic capabilities to create a unique digital system fingerprint.
- ▶ A proximity sensor wakes up the device when someone is nearby and automatically logs off when no one is nearby.

## Sustainability matters

- ▶ CX943adxse is designed for the circular economy.
- ▶ Automatic two-sided printing is standard, along with built-in energy-saving modes that help support ratings of EPEAT® Silver and ENERGY STAR® certified.
- ▶ The award-winning Lexmark Cartridge Collection Programme (LCCP) and Lexmark Equipment Collection Programme (LECP) minimise waste and support recycling (availability varies by country).

## Power up with IoT

- ▶ Our sophisticated, IoT-enabled printers are loaded with sensors that continuously monitor hundreds of data points.
- ▶ When you connect your device to Lexmark Cloud Services, you can optimise performance and uptime with additional features like predictive service and automatic supplies replenishment.

This is a Class A device according to international electromagnetic emissions standards (i.e. FCC Rules, EN 55022/EN 55032, etc.). Class A products are intended for use in non-residential/non-domestic environments. Use of a Class A product in residential/domestic environments may cause interference to radio communications and require corrective measures.

\* Print speeds measured in accordance with ISO/IEC 24734 (ESAT). For more information see: [www.lexmark.com/ISOspeeds](http://www.lexmark.com/ISOspeeds).

\*\* Average continuous black or continuous composite colour (CMY) declared yield in one-sided (simplex) mode up to this number of pages in accordance with ISO/IEC 19798. Actual yield will vary considerably based upon many factors. See [www.lexmark.com/yields](http://www.lexmark.com/yields) for more information.

\*\*\* The Trusted Platform Module (TPM) is not available in some countries.

# Lexmark CX943adxse

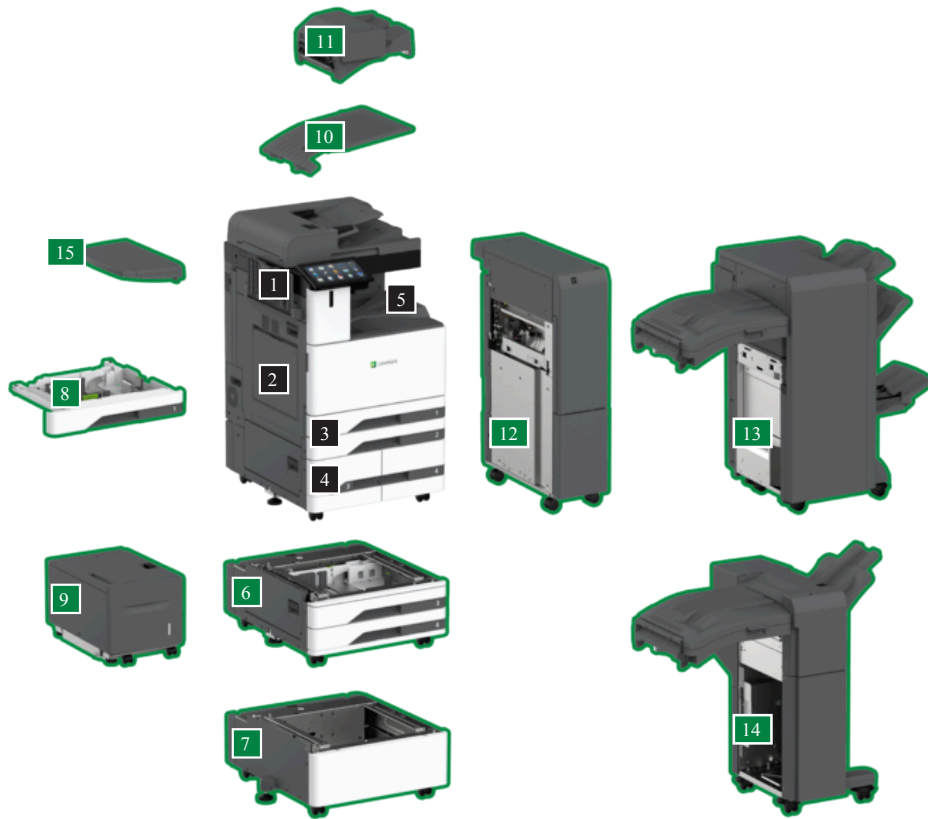

- 1 **Multifunction product with 25 cm touch screen**  
1141 x 620 x 754 mm
- 2 **100-Sheet multipurpose feeder**  
Dimensions included as part of base model
- 3 **2 x 520-Sheet tray**  
Dimensions included as part of base model
- 4 **2,000-Sheet tandem tray with casters**  
Dimensions included as part of base model
- 5 **400-Sheet output bin**  
Dimensions included as part of base model
- 6 **2 x 520-Sheet Tray**  
305.2 x 668.5 x 720 mm
- 7 **Caster Spacer**  
305 x 669 x 720 mm
- 8 **Envelope Tray**  
89.9 x 619.9 x 565.5 mm
- 9 **2,000-Sheet Tray (sidecar)**  
491 x 751 x 526 mm

- 10 **Dual Catch Bin**  
125 x 474 x 380 mm
- 11 **Inline Staple Finisher**  
238 x 478 x 460.5 mm
- 12 **Tri-Fold/Z-Fold Booklet Finisher**  
991 x 232 x 726 mm
- 13 **Booklet Staple (2/3) Hole Punch Finisher**  
1056 x 790 x 589 mm
- 14 **Staple (2/3) Hole Punch Finisher**  
983 x 962 x 653 mm
- 15 **Work Table**  
82 x 303 x 528 mm



**P/N** Hardware  
32D0420 Lexmark CX943adxse

**P/N** Supplies

- 25A0013 Staple Cartridges (3 pack)
- 73D0P00 Lexmark CS943, CX942, 943, 944, XC9445, 55, 65 Black 165K Photoconductor
- 73D0Q00 Lexmark CS943, CX942, 943, 944, XC9445, 55, 65 3-Pack 165K Photoconductor Kit
- 73D0W00 Lexmark CS943, CX942, 943, 944, XC9445, 55, 65 35K Waste Container
- 83D0HCO Lexmark CX942, 943, 944 Cyan 22K Toner Cartridge
- 83D0HKO Lexmark CX942, 943, 944 Black 45K Toner Cartridge
- 83D0HMO Lexmark CX942, 943, 944 Magenta 22K Toner Cartridge
- 83D0HYO Lexmark CX942, 943, 944 Yellow 22K Toner Cartridge

**P/N** Paper Handling

- 32D0810 Caster Spacer
- 32D0811 2 x 520-Sheet Tray with Casters
- 32D0812 2,000-Sheet Tandem Tray with Casters
- 32D0813 Envelope Tray
- 32D0815 Caster Cabinet
- 32D0816 2,000-Sheet Tray (sidecar)
- 32D0819 Dual Catch Bin
- 32D0820 Inline Staple Finisher
- 32D0823 Staple (2/3) Hole Punch Finisher
- 32D0824 Staple (2/4) Hole Punch Finisher
- 32D0825 Booklet Staple (2/3) Hole Punch Finisher
- 32D0826 Booklet Staple (2/4) Hole Punch Finisher
- 32D0831 Tri-Fold/Z-Fold Booklet Finisher

**P/N** Memory Options  
27X0400 500+ GB Hard Disk

**P/N** Application Solutions

- 57X0300 Contact Authentication Device
- 57X0301 Contactless Authentication Device
- 82S1203 IPDS License
- 82S1204 Bar Code License

**P/N** Connectivity

- 1021294 USB Cable (2 meter)
- 14F0100 RS-232C Serial Interface Card
- 27X0142 Lexmark MarkNet N8230 Fibre Ethernet Print Server
- 27X6410 Lexmark MarkNet N8372 802.11 a/b/g/n/ac Wireless Print Server
- 57X7040 English Keyboard Kit
- SPD0002 Surge protective device

**P/N** Furniture  
32D0809 CX94x Work Table

You can install one of the following: the Dual Catch Bin or the Inline Staple Finisher or the Staple Hole Punch Finisher or the Booklet Staple Hole Punch Finisher.

To install the Tri-Fold/Z-Fold Finisher, you must also install the Booklet Staple Hole Punch Finisher.

To install the Staple Hole Punch Finisher or Booklet Staple Hole Punch Finisher, you must also install the 2x520-Sheet Tray with Casters, the 2,000-Sheet Tandem Tray with Casters, or the Caster Spacer.

To install the 2,000-Sheet Tray (sidecar), you must also install the 2x520-Sheet Tray with Casters or the 2,000-Sheet Tandem Tray with Casters. It will not work with the Caster Spacer.

To install the Envelope Tray, you must remove Tray 1 and replace it with the Envelope Tray.

## Product Specifications

## Lexmark CX943adxse

Printing	
Display	Lexmark e-Task 10-inch (25 cm) class colour touch screen
Print speed	up to: black: 55 ppm <sup>1</sup> (A4) / colour: 55 ppm <sup>1</sup> (A4)
Time to first page	as fast as: black: 4.9 seconds / colour: 4.9 seconds
Print resolution	black: 1200 x 1200 dpi, 2400 IQ (2400 x 600 dpi) / colour: 1200 x 1200 dpi, 2400 IQ (2400 x 600 dpi)
Memory	standard: 4096 MB / maximum: 4096 MB
Hard Disk	Intelligent Storage Drive included; Magnetic Hard Disk (optional)
Recommended monthly page volume	7,000 - 50,000 pages <sup>2</sup>
Maximum monthly duty cycle	up to: 270 000 pages per month <sup>3</sup>
Copying	
Copy speed	up to: black: 55 cpm <sup>1</sup> (A4) / colour: 55 cpm <sup>1</sup> (A4)
Time to first copy	as fast as: black: 6.8 seconds / colour: 6.4 seconds
Scanning	
Scanner type / ADF scan	Flatbed scanner with automatic document feeder / DADF (single pass Duplex)
Duplex scan speed	up to: black: 146/144 spm (A4) / colour: 146/144 spm (A4)
Simplex scan speed	up to: black: 73.5/72 spm (A4) / colour: 73.5/72 spm (A4)
ADF paper input capacity	up to: 130 pages
Faxing	
Modem speed	ITU T.30, V.34 Half-Duplex, 33.6 kbps
Supplies <sup>4</sup>	
Cartridge yields	up to: 22,000 <sup>5</sup> -page colour (CMY) cartridges / up to: 45,000 <sup>5</sup> -page Black Cartridge
Cartridge(s) shipped with product	18,500 <sup>5</sup> -page black toner cartridge <sup>5</sup> , 11,500 <sup>5</sup> -page Colour (CMY) Toner Cartridges <sup>5</sup>
Paper Handling	
Standard paper handling	100-Sheet Multipurpose Feeder, 2 x 520-Sheet Tray, 2000-Sheet Tandem Tray/Caster, 400-Sheet Output Bin
Optional paper handling	Booklet staple hole punch finisher, Inline Stapler, Dual Catch Bin, Envelope Tray, 2 x 520-Sheet Tray/Caster, Caster spacer, Tri-fold/Z-fold booklet finisher, Staple Punch Finisher, Work table, 2000-Sheet Tray
Paper input capacity	up to: standard: 3140 pages / maximum: 5140 pages
Paper output capacity	up to: standard: 400 pages / maximum: 2000 pages
Media types supported	Labels, Card Stock, Plain Paper, Envelopes, Glossy paper, Refer to the Paper & Specialty Media Guide
Media sizes supported	A6, Oficio, 7 3/4 Envelope, JIS-B4, 9 Envelope, B5, JIS-B5, A3, Ledger, A4, Legal, SRA3, A5, Hagaki card, Letter, B5 Envelope, C4 Envelope, Statement, C5 Envelope, Executive, DL Envelope, Folio, 10 Envelope
General Information	
Standard connectivity	Gigabit Ethernet (10/100/1000), Front USB 2.0 Specification Hi-Speed Certified port (Type A), Rear USB 2.0 Hi-Speed certified port (type A), USB 2.0 Specification Hi-Speed Certified (Type B), One Internal Card Slot
Optional network ports / Optional local ports	MarkNet N8230 Fiber Ethernet Print Server, Marknet N8372 WiFi Option / Internal RS-232C serial
Noise Level	Operating: 49 dBA (Print) / 57 dBA (Copy) / 56 dBA (Scan)
Specified operating environment	Humidity: 8 to 80% Relative Humidity / Altitude: 0 - 2500 Metres (8,200 Feet) / Temperature: 10 to 32°C (50 to 90°F)
Product guarantee	1-Year Onsite Repair, Next Business Day
Size / Weight	HxWxD: 1141 x 620 x 754 mm / 145.4 kg
Energy Star Typical Electricity Consumption	TEC: 0.85 kWh per week

All information is subject to change without notice. Lexmark is not liable for any errors or omissions.

<sup>1</sup> Print and copy speeds measured in accordance with ISO/IEC 24734 and ISO/IEC 24735 respectively (ESAT). For more information see: [www.lexmark.com/ISOspeeds](http://www.lexmark.com/ISOspeeds).

<sup>2</sup> "Recommended Monthly Page Volume" is a range of pages that helps customers evaluate Lexmark's product offerings based on the average number of pages customers plan to print on the device each month. Lexmark recommends that the number of pages per month be within the stated range for optimum device performance, based on factors including: supplies replacement intervals, paper loading intervals, speed, and typical customer usage. <sup>3</sup> "Maximum Monthly Duty Cycle" is defined as the maximum number of pages a device could deliver in a month using a multishift operation. This metric provides a comparison of robustness in relation to other Lexmark printers and MFPs. <sup>4</sup> Product functions only with replacement cartridges designed for use in a specific geographical region. See [www.lexmark.com/regions](http://www.lexmark.com/regions) for more details. <sup>5</sup> Average continuous black or continuous composite CMY declared cartridge yield up to this number of standard pages in accordance with ISO/IEC 19798.

This is a Class A device according to international electromagnetic emissions standards (i.e. FCC Rules, EN 55022/EN 55032, etc.). Class A products are intended for use in non-residential/non-domestic environments. Use of a Class A product in residential/domestic environments may cause interference to radio communications and require corrective measures.

© 2022 Lexmark. All rights reserved.

Lexmark and the Lexmark logo are trademarks of Lexmark International, Inc., registered in the United States and/or other countries.

Apple and AirPrint are trademarks of Apple Inc., registered in the U.S. and other countries and regions. MOPRIA<sup>®</sup>, the Mopria<sup>®</sup> Logo, and the Mopria Alliance<sup>™</sup> word mark and logo are registered and/or unregistered trademarks and service marks of Mopria Alliance, Inc. in the United States and other countries. Unauthorised use is strictly prohibited. ENERGY STAR and the ENERGY STAR mark are registered trademarks owned by the U.S. Environmental Protection Agency. EPEAT is a trademark of the Green Electronics Council in the United States and other countries. PANTONE<sup>®</sup> is the property of Pantone LLC. All other trademarks are the property of their respective owners.

This product includes software developed by the OpenSSL Project for use in the Open SSL Toolkit (<http://www.openssl.org/>).

