



Lexmark CX942adse

The Lexmark CX942adse large-format colour multifunction is designed for security, versatility and performance for large workgroups at speeds of up to 45 pages per minute*.

Part Number

32D0320

Print Technology

Colour Laser

Function

Colour Copying, Colour Faxing, Colour Printing, Colour Scanning, Colour Network Scanning, Trusted Platform Module (TPM), The Trusted Platform Module (TPM) is not available in some countries.

Workgroup Size

Large Workgroup

Touch Screen Display

Yes

Display

Lexmark e-Task 10-inch (25 cm) class colour touch screen

Print Speed (A4, Black)

Up to 45 ppm⁴

Print Speed (A4, Colour)

Up to 45 ppm⁴

Print Speed (A4, Black) Duplex

Up to 45 spm⁴

Print Speed (A4, Colour) Duplex

Up to 45 spm⁴

Time to First Page (Black)

As fast as 6.0 seconds

Time to First Page (Colour)

As fast as 6.1 seconds

Duplex (2-sided) Printing

Integrated Duplex

Print Resolution, Black

1200 x 1200 dpi, 2400 IQ (2400 x 600 dpi)

Print Resolution, Colour

1200 x 1200 dpi, 2400 IQ (2400 x 600 dpi)

Copy Speed (A4, Black)

Up to 45 cpm⁴

Copy Speed (A4, Colour)

Up to 45 cpm⁴

Copy Speed (A4, Black) Duplex

Up to 45 spm⁴

Copy Speed (A4, Colour) Duplex

Up to 45 spm⁴

Time to First Copy (Black)

As fast as 8.1 seconds

Time to First Copy (Colour)

As fast as 7.9 seconds

Reduce / Enlarge Range

25 - 400 %

A4/Ltr Simplex Scan Speed (Black)

Up to 73.5/72 sides per minute

A4/Ltr Simplex Scan Speed (Colour)

Up to 73.5/72 sides per minute

A4/Ltr Duplex Scan Speed (Black)

Up to 146/144 sides per minute

A4/Ltr Duplex Scan Speed (Colour)

Up to 146/144 sides per minute

Scan Area, Maximum (mm)

297 x 432 mm

ADF Scan

DADF (single pass Duplex)

Scanner Type

Flatbed scanner with automatic document feeder

Scan Resolution, Enhanced

600 x 600 dpi

Scan Resolution, Optical

300 x 600

Optical Scanning Resolution

300 x 600 dpi

Scan File Formats (Send as)

JPEG, JPG, PDF, Secure PDF, TIFF, Archival PDF (A-1a, A-1b), Searchable PDF

Scan Destinations

e-mail, FTP, USB Flash drive, USB or Network connected computer

Modem Speed

ITU T.30, V.34 Half-Duplex, 33.6 Kbps

Fax Transmission Speed

< 3 seconds per page

Processor Speed

Quad Core 1.2 GHz

Memory, Standard

4096 MB

Memory, Maximum

4096 MB

Hard Disk

Intelligent Storage Drive included; Magnetic Hard Disk available

Apple Operating Systems Supported

Support is provided through AirPrint and AirScan only

Citrix MetaFrame

Microsoft Windows Server 2003 and 2003 X64 Edition with Citrix XenApp 5.0, Microsoft Windows Server 2008 and 2008 X64 Edition with Citrix XenApp 5.0, Microsoft Windows Server 2012 R2 Datacenter Edition running Citrix XenApp 7.5, 6, 7, 8, 9, 11, 12, 13, 14, 15, 16, Microsoft Windows Server 2012 Datacenter Edition running Citrix XenApp 7.5, 6, 7, 8, 9, 11, 12, 13, 14, 15, 16, Microsoft Windows Server 2012 Foundation running Citrix XenApp 6.0, 6.5, Microsoft Windows Server 2012 Essentials running Citrix XenApp 6.0, 6.5, Microsoft Windows Server 2012 Standard running Citrix XenApp 6.0, 6.5, Microsoft Windows Server 2008 R2 Datacenter Edition running Citrix XenApp 7.5, 6, 7, 8, 9, 11, 12, 13, 14, 15, 16, Microsoft Windows Server 2008 R2 Enterprise Edition running Citrix XenApp 6.0, 6.5, Microsoft Windows Server 2008 R2 Standard Edition running Citrix XenApp 6.0, 6.5

Linux Operating Systems Supported

openSUSE Linux 42.3, Fedora 27, 28, 29, Ubuntu 16.04, 18.04 LTS, Debian GNU/Linux 8.11, openSUSE Linux 15, Debian 9.4, Debian GNU/Linux 9.5, Debian GNU/Linux 9.6, Red Hat Linux 7.5, 7.6

Microsoft Windows Operating Systems Supported

Windows 2000, Windows NT (4.00/4.00 Server), Windows Me, Windows XP, Windows Server 2003, Windows 98 2nd Edition, Windows XP x64, Windows Server 2003 running Terminal Services, Windows 2000 Server running Terminal Services, Windows Server 2003 x64, Windows Server 2003 x64 running Terminal Services, Windows Vista, Windows Vista x64, Windows Server 2008, Windows Server 2008 x64, Windows Server 2008 running Terminal Services, Windows Server 2008 x64 running Terminal Services, Windows 7, Windows 7 x64, Windows Server 2008 R2, Windows Server 2008 R2 running Terminal Services, Windows 8, Windows 8 x64, Windows Server 2012, Windows 8.1, Windows 8.1 x64, Windows Server 2012 R2, Windows RT, Windows 10, Windows Server 2016, Windows Server 2019, Windows Server 2022, Windows 11

Novell Operating Systems Supported

Novell NetWare 6.5 Open Enterprise Server, Novell Open Enterprise Server 2 (SP3) on SuSE Linux Enterprise Server 10 SP4 (x86 and x64) 3, Novell Open Enterprise Server 11 (SP3) on SuSE Linux Enterprise Server 11 SP4 (x86 and x64), Novell Open Enterprise Server 11 (SP3) on SuSE Linux Enterprise Server 12 SP1 (x86 and x64), Novell Open Enterprise Server 15 (SP1) on SuSE Linux Enterprise Server 11 SP4 (x86 and x64)

Included Paper Handling

100-Sheet Multipurpose Feeder, 400-Sheet Output Bin, 2 x 520-Sheet Tray

Optional Paper Handling

Staple Punch Finisher, Inline Stapler, Envelope Tray, 2000-Sheet Tandem Tray/Caster, 2000-Sheet Tray, Dual Catch Bin, Work table, 2 x 520-Sheet Tray/Caster, Caster spacer, Tri-fold/Z-fold booklet finisher, Booklet staple hole punch finisher

Paper Input Capacity, Standard

Up to 1140 pages 75 gsm bond

Paper Input Capacity, Maximum

Up to 5140 pages 75 gsm bond

Paper Output Capacity, Standard

Up to 400 pages 75 gsm bond

Paper Output Capacity, Maximum

Up to 2000 pages 75 gsm bond

Paper Weight Range Supported - Standard Tray (gsm)

52 - 300 gsm

Paper Weight Range Supported - Multipurpose Feeder (gsm)

52 - 300 gsm

A3

Yes

ADF

130-Sheet Automatic Document Feeder

ADF Paper Input Capacity

Up to 130 pages 75 gsm bond

ADF Paper Output Capacity

Up to 130 pages 75 gsm bond

Finishing Option

Yes

Finishing Functions

Offset stacking, Stapling, Hole punching, Booklet fold and saddle stapling

Number of Paper Inputs, Standard

3

Number of Paper Inputs, Maximum

6

Media Types Supported

Card Stock, Envelopes, Glossy paper, Labels, Plain Paper, Refer to the Paper & Specialty Media Guide

Media Sizes Supported

10 Envelope, 7 3/4 Envelope, 9 Envelope, A3, A4, A5, B5 Envelope, C4 Envelope, C5 Envelope, DL Envelope, B5, Hagaki Card, Executive, Folio, JIS-B4, JIS-B5, Ledger, Legal, Letter, Statement, Oficio, A6, SRA3

Standard Connectivity

One Internal Card Slot, USB 2.0 Specification Hi-Speed Certified (Type B), Gigabit Ethernet (10/100/1000), Front USB 2.0 Specification Hi-Speed Certified port (Type A), Rear USB 2.0 Specification Hi-Speed Certified port (Type A)

Optional Local Ports

Internal RS-232C serial

Optional Network Ports

MarkNet N8230 Fiber Ethernet Print Server, Marknet N8372 WiFi Option

Direct USB

Yes

Ethernet Network

Yes

Network Protocol Support

TCP, UDP, IPSEC w/ IPv4, IPSEC w/ IPv6, ICMP, IGMP, IPv4, IPv6

Network Printing Methods

Enhanced IP (Port 9400), IPP 1.0, 1.1, 2.0 (Internet Printing Protocol), Microsoft Web Services WSD, Pull Printing

Network Management Protocols

WINS, APIPA (AutoIP), DHCP, DNS, DDNS, mDNS, ARP, BOOTP

Network Security

SNMPv3, 802.1x Authentication: MD5, MSCHAPv2, LEAP, PEAP, TLS, TTLS, Certificate Management, SSL Cipher Configuration, TCP/UDP Port Access Control, Security Port Lockdown, TCP Restricted Server List, IPSEC Support (IPv4/IPv6)

Printable Area (metric)

4.2 mm of the top, bottom, right and left edges (within)

Printer Languages (Standard)

PCL 6 Emulation, Personal Printer Data Stream (PPDS), PostScript 3 Emulation, Direct Image, PDF 1.7 emulation, PCL 5, PCLm

Fonts and Symbol Sets

158 scalable PostScript fonts, 39 scalable PPDS fonts, 5 PPDS bitmap fonts, For more information, refer to the Technical Reference., 89 scalable PCL 5/6 fonts, 2 PCL 5/6 bitmap fonts

Laser Cartridge Yields (up to)³

22,000-page Colour (CMY) Cartridges, , 45,000-page Black Cartridge

Photoconductor Estimated Yield, Black

Up to 165,000 pages, based on 5 average letter/A4-size pages per print job

Photoconductor Estimated Yield, CMY

Up to 165,000 pages, based on 5 average letter/A4-size pages per print job

Cartridge(s) Shipping with Product

18,500-page Black Toner Cartridge, 11,500-page Colour (CMY) Toner Cartridges

Replacement Cartridges:

Product functions only with replacement cartridges designed for use in a specific geographical region. See www.lexmark.com/ regions for more details.

Packaged Size (mm - H x W x D)

1100 x 751 x 849 mm

Packaged Weight, kg

124.4 kg

Size (mm - H x W x D)

880 x 620 x 754 mm

Weight

105 kg

Noise level (Idle mode)

29 dBA

Noise Level (Print), Operating

48 dBA

Duplex Print Noise Level, Operating

50 dBA

Noise Level (Copy), Operating

57 dBA

Noise Level (Scan), Operating

56 dBA

ENERGY STAR

Yes

Average Power (Hibernate Mode)

0.1 watts

Average Power (Sleep Mode)

1.2 watts

Average Power (Ready Mode)

96 watts

Average Power (Printing)

710 watts

Average Power while Printing Duplex

640 watts

ENERGY STAR Typical Electricity**Consumption (TEC)**

0.73 kilowatt-hours per week

Product Guarantee

1-Year Onsite Repair, Next Business Day

Product Certifications

ENERGY STAR, ICES-003 Class A, BSMI Class A, VCCI Class A, FCC Class A, NOM-032, UL, cUL, NOM, US FDA/CDRH, IEC 60825-1, CB Report, ISO-532B, CE (EU) DoC, EFTA (CE), KC logo, CCC, C-tick DoC, EuP, CECP, CEL, EC 1275/2008, ECMA-370, TED, SIL, TER, SABS, UL-AR, GS Mark, Green Dot, ISO-9296, COC, CCD-035 EcoLogo, Green Mark, EPEAT, China Green Product (CGP), Mopria Certified

Maximum Monthly Duty Cycle

Up to 200 000 pages per month²

Recommended Monthly Page Volume

7,000 - 50,000 pages¹

Specified Operating Environment

Humidity: 8 to 80% Relative Humidity, Altitude: 0 - 2500 Metres (8,200 Feet), Temperature: 10 to 32°C (50 to 90°F)

Country of Origin

North America & TAA Compliant - Mexico, Rest of World - Vietnam

UNSPSC Code

43212110

¹"Recommended Monthly Page Volume" is a range of pages that helps customers evaluate Lexmark's product offerings based on the average number of pages customers plan to print on the device each month. Lexmark recommends that the number of pages per month be within the stated range for optimum device performance, based on factors including: supplies replacement intervals, paper loading intervals, speed, and typical customer usage.

²"Maximum Monthly Duty Cycle" is defined as the maximum number of pages a device could deliver in a month using a multishift operation. This metric provides a comparison of robustness in relation to other Lexmark printers and MFPs.

³Average continuous black or continuous composite CMY declared cartridge yield up to this number of standard pages in accordance with ISO/IEC 19798.

⁴Print and copy speeds measured in accordance with ISO/IEC 24734 and ISO/IEC 24735 respectively (ESAT). For more information see: www.lexmark.com/ISOspeeds.

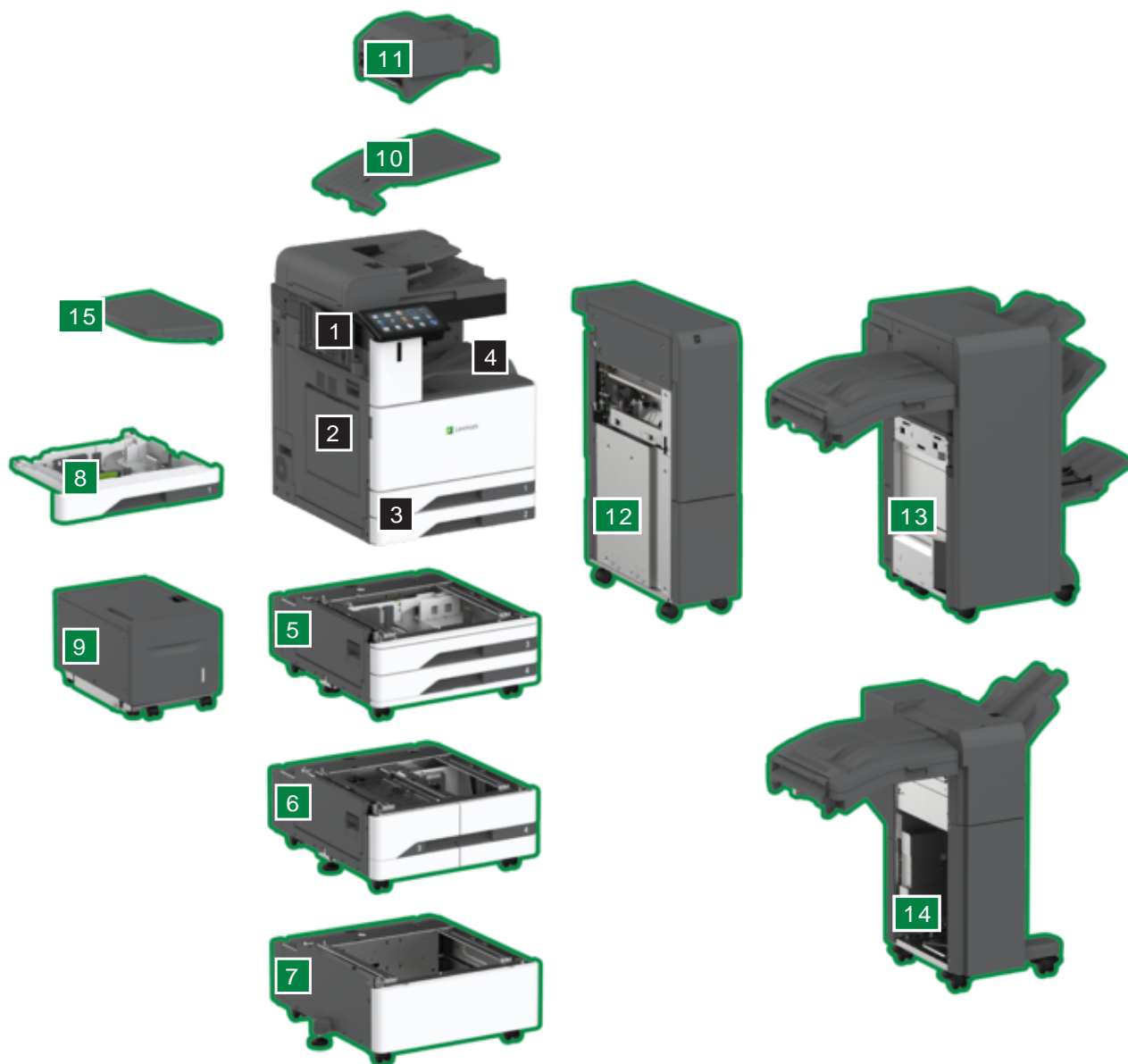

Callout	Availability	Description
1	Standard	25 cm (10-inch) Colour Touch Screen
10	Optional	Dual Catch Bin
11	Optional	Inline Stapler
12	Optional	Tri-fold/Z-fold booklet finisher
13	Optional	Booklet staple hole punch finisher
14	Optional	Staple Punch Finisher
15	Optional	Work Table
2	Standard	100-Sheet Multipurpose Feeder
3	Standard	2 x 520-Sheet Tray
4	Standard	400-Sheet Output Bin
5	Optional	2 x 520-Sheet Tray with casters
6	Optional	2,000-Sheet Tandem Tray with casters
7	Optional	Caster Spacer
8	Optional	Envelope Tray
9	Optional	2,000-Sheet Tray (sidecar)

P/N	Toner Cartridges	P/N	Extended Warranties
83D0HC0	Lexmark CX942, 943, 944 Cyan 22K Toner Cartridge	2373386	CX942 3-Year Renewal Onsite Repair, Response Time Next Business Day
83D0HM0	Lexmark CX942, 943, 944 Magenta 22K Toner Cartridge	2373387	CX942 4-Year Renewal Onsite Repair, Response Time Next Business Day
83D0HY0	Lexmark CX942, 943, 944 Yellow 22K Toner Cartridge		
83D0HK0	Lexmark CX942, 943, 944 Black 45K Toner Cartridge	2373403	CX942 1-Year Parts Only Extended Warranty
73D0P00	Lexmark CS943, CX942, 943, 944, XC9445, 55, 65 Black 165K Photoconductor	2373404	CX942 2-Year Parts Only Extended Warranty
73D0Q00	Lexmark CS943, CX942, 943, 944, XC9445, 55, 65 3-Pack 165K Photoconductor Kit	2373405	CX942 3-Year Parts Only Extended Warranty
73D0W00	Lexmark CS943, CX942, 943, 944, XC9445, 55, 65 35K Waste Container	2373406	CX942 4-Year Parts Only Extended Warranty
25A0013	Staple Cartridges (3 pack)	2373407	CX942 5-Year Parts Only Extended Warranty
		2373408	CX942 6-Year Parts Only Extended Warranty
		2373409	CX942 1-Year Renewal Parts Only
		2373410	CX942 2-Year Renewal Parts Only
		2373411	CX942 3-Year Renewal Parts Only
		2373412	CX942 4-Year Renewal Parts Only
P/N	Paper Handling		
32D0811	2 x 520-Sheet Tray with Casters		
32D0812	2,000-Sheet Tandem Tray with Casters		
32D0813	Envelope Tray		
32D0816	2,000-Sheet Tray (sidecar)		
32D0819	Dual Catch Bin		
32D0820	Inline Staple Finisher		
32D0825	Booklet Staple (2/3) Hole Punch Finisher		
32D0826	Booklet Staple (2/4) Hole Punch Finisher		
32D0823	Staple (2/3) Hole Punch Finisher		
32D0824	Staple (2/4) Hole Punch Finisher		
32D0810	Caster Spacer		
32D0831	Tri-Fold/Z-Fold Booklet Finisher		
32D0815	Caster Cabinet		
P/N	Furniture		
32D0809	CX94x Work Table		
P/N	Memory Options		
27X0400	500+ GB Hard Disk		
57X0070	Removable Hard Disk Enclosure Kit		
P/N	Application Solutions		
57X0300	Contact Authentication Device		
57X0301	Contactless Authentication Device		
82S1204	Bar Code License		
82S1203	IPDS License		
P/N	Connectivity		
27X0142	Lexmark MarkNet™ N8230 Fiber Ethernet Print Server		
27X6410	Lexmark MarkNet N8372 802.11 a/b/g/n/ac Wireless Print Server		
57X7040	English Keyboard Kit		
1021294	USB (2 Meter) Cable		
14F0100	RS-232C Serial Interface Card		
SPD0002	Surge Protective Device, 220-240V		
P/N	Extended Warranties		
2373378	CX942 1-Year Onsite Repair NBD Warranty		
2373379	CX942 2-Year Onsite Repair NBD Warranty		
2373380	CX942 3-Year Onsite Repair NBD Warranty		
2373381	CX942 4-Year Onsite Repair NBD Warranty		
2373382	CX942 5-Year Onsite Repair NBD Warranty		
2373383	CX942 6-Year Onsite Repair NBD Warranty		
2373385	CX942 2-Year Renewal Onsite Repair, Response Time Next Business Day		