



# Lexmark CX944adtse

The Lexmark CX944adtse large-format colour multifunction is designed for security, versatility and performance for large workgroups at speeds of up to 65 pages per minute\*.

**Part Number**

32D0470

**Print Technology**

Colour Laser

**Function**

Colour Copying, Colour Faxing, Colour Printing, Colour Scanning, Colour Network Scanning, Trusted Platform Module (TPM), The Trusted Platform Module (TPM) is not available in some countries.

**Workgroup Size**

Large Workgroup

**Touch Screen Display**

Yes

**Display**

Lexmark e-Task 10.1-inch (25.6 cm) colour touch screen

**Print Speed (A4, Black)**

Up to 65 ppm<sup>4</sup>

**Print Speed (A4, Colour)**

Up to 65 ppm<sup>4</sup>

**Print Speed (A4, Black) Duplex**

Up to 65 spm<sup>4</sup>

**Print Speed (A4, Colour) Duplex**

Up to 65 spm<sup>4</sup>

**Time to First Page (Black)**

As fast as 4.7 seconds

**Time to First Page (Colour)**

As fast as 5.2 seconds

**Duplex (2-sided) Printing**

Integrated Duplex

**Print Resolution, Black**

1200 x 1200 dpi, 2400 IQ (2400 x 600 dpi)

**Print Resolution, Colour**

1200 x 1200 dpi, 2400 IQ (2400 x 600 dpi)

**Copy Speed (A4, Black)**

Up to 65 cpm<sup>4</sup>

**Copy Speed (A4, Colour)**

Up to 65 cpm<sup>4</sup>

**Copy Speed (A4, Black) Duplex**

Up to 65 spm<sup>4</sup>

**Copy Speed (A4, Colour) Duplex**

Up to 65 spm<sup>4</sup>

**Time to First Copy (Black)**

As fast as 6.6 seconds

**Time to First Copy (Colour)**

As fast as 6.3 seconds

**Reduce / Enlarge Range**

25 - 400 %

**A4/Ltr Simplex Scan Speed (Black)**

Up to 73.5/72 sides per minute

**A4/Ltr Simplex Scan Speed (Colour)**

Up to 73.5/72 sides per minute

**A4/Ltr Duplex Scan Speed (Black)**

Up to 146/144 sides per minute

**A4/Ltr Duplex Scan Speed (Colour)**

Up to 146/144 sides per minute

**Scan Area, Maximum (mm)**

297 x 432 mm

**ADF Scan**

DADF (single pass Duplex)

**Scanner Type**

Flatbed scanner with automatic document feeder

**Scan Resolution, Enhanced**

Up to 600 x 600 dpi

**Scan Resolution, Optical**

Up to 600 dpi

**Scan File Formats (Send as)**

JPEG, JPG, PDF, Secure PDF, TIFF, Archival PDF (A-1a, A-1b), Searchable PDF

**Scan Destinations**

e-mail, FTP, USB Flash drive, USB or Network connected computer

**Modem Speed**

ITU T.30, V.34 Half-Duplex, 33.6 Kbps

**Fax Transmission Speed**

< 3 seconds per page

**Processor Speed**

Quad Core 1.2 GHz

**Memory, Standard**

4096 MB

**Memory, Maximum**

4096 MB

**Hard Disk**

Intelligent Storage Drive included; Magnetic Hard Disk (optional)

**Apple Operating Systems Supported**

Support is provided through AirPrint and AirScan only

**Citrix MetaFrame**

Microsoft Windows Server 2003 and 2003 X64 Edition with Citrix XenApp 5.0, Microsoft Windows Server 2008 and 2008 X64 Edition with Citrix XenApp 5.0, Microsoft Windows Server 2012 R2 Datacenter Edition running Citrix XenApp 7.5, 6, 7, 8, 9, 11, 12, 13, 14, 15, 16, Microsoft Windows Server 2012 Datacenter Edition running Citrix XenApp 7.5, 6, 7, 8, 9, 11, 12, 13, 14, 15, 16, Microsoft Windows Server 2012 Foundation running Citrix XenApp 6.0, 6.5, Microsoft Windows Server 2012 Essentials running Citrix XenApp 6.0, 6.5, Microsoft Windows Server 2012 Standard running Citrix XenApp 6.0, 6.5, Microsoft Windows Server 2008 R2 Datacenter Edition running Citrix XenApp 7.5, 6, 7, 8, 9, 11, 12, 13, 14, 15, 16, Microsoft Windows Server 2008 R2 Enterprise Edition running Citrix XenApp 6.0, 6.5, Microsoft Windows Server 2008 R2 Standard Edition running Citrix XenApp 6.0, 6.5

**Linux Operating Systems Supported**

openSUSE Linux 42.3, Fedora 27, 28, 29, Ubuntu 16.04, 18.04 LTS, Debian GNU/Linux 8.11, openSUSE Linux 15, Debian 9.4, Debian GNU/Linux 9.5, Debian GNU/Linux 9.6, Red Hat Linux 7.5, 7.6

**Microsoft Windows Operating Systems Supported**

Windows 2000, Windows NT (4.00/4.00 Server), Windows Me, Windows XP, Windows Server 2003, Windows 98 2nd Edition, Windows XP x64, Windows Server 2003 running Terminal Services, Windows 2000 Server running Terminal Services, Windows Server 2003 x64, Windows Server 2003 x64 running Terminal Services, Windows Vista, Windows Vista x64, Windows Server 2008, Windows Server 2008 x64, Windows Server 2008 running Terminal Services, Windows Server 2008 x64 running Terminal Services, Windows 7, Windows 7 x64, Windows Server 2008 R2, Windows Server 2008 R2 running Terminal Services, Windows 8, Windows 8 x64, Windows Server 2012, Windows 8.1, Windows 8.1 x64, Windows Server 2012 R2, Windows RT, Windows 10, Windows Server 2016, Windows Server 2019, Windows Server 2022, Windows 11

**Novell Operating Systems Supported**

Novell NetWare 6.5 Open Enterprise Server, Novell Open Enterprise Server 2 (SP3) on SuSE Linux Enterprise Server 10 SP4 (x86 and x64) 3, Novell Open Enterprise Server 11 (SP3) on SuSE Linux Enterprise Server 11 SP4 (x86 and x64), Novell Open Enterprise Server 11 (SP3) on SuSE Linux Enterprise Server 12 SP1 (x86 and x64), Novell Open Enterprise Server 15 (SP1) on SuSE Linux Enterprise Server 11 SP4 (x86 and x64)

**Included Paper Handling**

100-Sheet Multipurpose Feeder, 400-Sheet Output Bin, 2 x 520-Sheet Tray/Caster, 2 x 520-Sheet Tray

**Optional Paper Handling**

Staple Punch Finisher, Inline Stapler, Envelope Tray, 2000-Sheet Tandem Tray/Caster, 2000-Sheet Tray, Dual Catch Bin, Work table, Caster spacer, Tri-fold/Z-fold booklet finisher, Booklet staple hole punch finisher

**Paper Input Capacity, Standard**

Up to 2180 pages 75 gsm bond

**Paper Input Capacity, Maximum**

Up to 4180 pages 75 gsm bond

**Paper Output Capacity, Standard**

Up to 400 pages 75 gsm bond

**Paper Output Capacity, Maximum**

Up to 2000 pages 75 gsm bond

**Paper Weight Range Supported - Standard Tray (gsm)**

52 - 300 gsm

**Paper Weight Range Supported - Multipurpose Feeder (gsm)**

52 - 300 gsm

**A3**

Yes

**ADF**

130-Sheet Automatic Document Feeder

**ADF Paper Input Capacity**

Up to 130 pages 75 gsm bond

**ADF Paper Output Capacity**

Up to 130 pages 75 gsm bond

**Finishing Option**

Yes

**Finishing Functions**

Offset stacking, Stapling, Hole punching, Booklet fold and saddle stapling

**Number of Paper Inputs, Standard**

5

**Number of Paper Inputs, Maximum**

6

**Media Types Supported**

Card Stock, Envelopes, Glossy paper, Labels, Plain Paper, Refer to the Paper & Specialty Media Guide

**Media Sizes Supported**

10 Envelope, 7 3/4 Envelope, 9 Envelope, A3, A4, A5, B5 Envelope, C4 Envelope, C5 Envelope, DL Envelope, B5, Hagaki Card, Executive, Folio, JIS-B4, JIS-B5, Ledger, Legal, Letter, Statement, Oficio, A6, SRA3

**Standard Connectivity**

One Internal Card Slot, USB 2.0 Specification Hi-Speed Certified (Type B), Gigabit Ethernet (10/100/1000), Front USB 2.0 Specification Hi-Speed Certified port (Type A), Rear USB 2.0 Specification Hi-Speed Certified port (Type A)

**Optional Local Ports**

Internal RS-232C serial

**Optional Network Ports**

MarkNet N8230 Fiber Ethernet Print Server, Marknet N8372 WiFi Option

**Direct USB**

Yes

**Ethernet Network**

Yes

**Network Protocol Support**

TCP, UDP, IPSEC w/ IPv4, IPSEC w/ IPv6, ICMP, IGMP, IPv4, IPv6

**Network Printing Methods**

Enhanced IP (Port 9400), IPP 1.0, 1.1, 2.0 (Internet Printing Protocol), Microsoft Web Services WSD, Pull Printing

**Network Management Protocols**

WINS, APIPA (AutoIP), DHCP, DNS, DDNS, mDNS, ARP, BOOTP

**Network Security**

SNMPv3, 802.1x Authentication: MD5, MSCHAPv2, LEAP, PEAP, TLS, TTLS, Certificate Management, SSL Cipher Configuration, TCP/UDP Port Access Control, Security Port Lockdown, TCP Restricted Server List, IPSEC Support (IPv4/IPv6)

**Printable Area (metric)**

4.2 mm of the top, bottom, right and left edges (within)

**Printer Languages (Standard)**

PCL 6 Emulation, Personal Printer Data Stream (PPDS), PostScript 3 Emulation, Direct Image, PDF 1.7 emulation, PCL 5, PCLm

**Fonts and Symbol Sets**

158 scalable PostScript fonts, 39 scalable PPDS fonts, 5 PPDS bitmap fonts, For more information, refer to the Technical Reference., 89 scalable PCL 5/6 fonts, 2 PCL 5/6 bitmap fonts

**Laser Cartridge Yields (up to)<sup>3</sup>**

22,000-page Colour (CMY) Cartridges, , 45,000-page Black Cartridge

**Photoconductor Estimated Yield, Black**

Up to 165,000 pages, based on 5 average letter/A4-size pages per print job

**Photoconductor Estimated Yield, CMY**

Up to 165,000 pages, based on 5 average letter/A4-size pages per print job

**Cartridge(s) Shipping with Product**

18,500-page Black Toner Cartridge, 11,500-page Colour (CMY) Toner Cartridges

**Replacement Cartridges:**

Product functions only with replacement cartridges designed for use in a specific geographical region. See [www.lexmark.com/](http://www.lexmark.com/) regions for more details.

**Packaged Size (mm - H x W x D)**

1326 x 751 x 849 mm

**Packaged Weight, kg**

156.6 kg

**Size (mm - H x W x D)**

1141 x 620 x 754 mm

**Weight**

115.5 kg

**Size, Trays Extended (mm - H x W x D)**

1553 x 953 x 1246 mm

**Noise level (Idle mode)**

29 dBA

**Noise Level (Print), Operating**

52 dBA

**Duplex Print Noise Level, Operating**

52 dBA

**Noise Level (Copy), Operating**

57 dBA

**Noise Level (Scan), Operating**

56 dBA

**ENERGY STAR**

Yes

**Average Power (Hibernate Mode)**

0.1 watts

**Average Power (Sleep Mode)**

1.2 watts

**Average Power (Ready Mode)**

88 watts

**Average Power (Printing)**

840 watts

**Average Power while Printing Duplex**

770 watts

**ENERGY STAR Typical Electricity****Consumption (TEC)**

1 kilowatt-hours per week

**Product Guarantee**

1-Year Onsite Repair, Next Business Day

**Product Certifications**

ENERGY STAR, ICES-003 Class A, BSMI Class A, VCCI Class A, FCC Class A, NOM-032, UL, cUL, NOM, US FDA/CDRH, IEC 60825-1, CB Report, ISO-532B, CE (EU) DoC, EFTA (CE), KC logo, CCC, C-tick DoC, EuP, CECP, CEL, EC 1275/2008, ECMA-370, TED, SII, TER, SABS, UL-AR, GS Mark, Green Dot, ISO-9296, COC, CCD-035 EcoLogo, Green Mark, EPEAT, China Green Product (CGP), Mopria Certified

**Maximum Monthly Duty Cycle**

Up to 340 000 pages per month<sup>2</sup>

**Recommended Monthly Page Volume**

7000 - 50000 pages<sup>1</sup>

**Specified Operating Environment**

Humidity: 8 to 80% Relative Humidity, Altitude: 0 - 2500 Metres (8,200 Feet), Temperature: 10 to 32°C (50 to 90°F)

**Country of Origin**

North America & TAA Compliant - Mexico, Rest of World - Vietnam

**UNSPSC Code**

43212110

<sup>1</sup>"Recommended Monthly Page Volume" is a range of pages that helps customers evaluate Lexmark's product offerings based on the average number of pages customers plan to print on the device each month. Lexmark recommends that the number of pages per month be within the stated range for optimum device performance, based on factors including: supplies replacement intervals, paper loading intervals, speed, and typical customer usage.

<sup>2</sup>"Maximum Monthly Duty Cycle" is defined as the maximum number of pages a device could deliver in a month using a multishift operation. This metric provides a comparison of robustness in relation to other Lexmark printers and MFPs.

<sup>3</sup>Average continuous black or continuous composite CMY declared cartridge yield up to this number of standard pages in accordance with ISO/IEC 19798.

<sup>4</sup>Print and copy speeds measured in accordance with ISO/IEC 24734 and ISO/IEC 24735 respectively (ESAT). For more information see: [www.lexmark.com/ISOspeeds](http://www.lexmark.com/ISOspeeds).

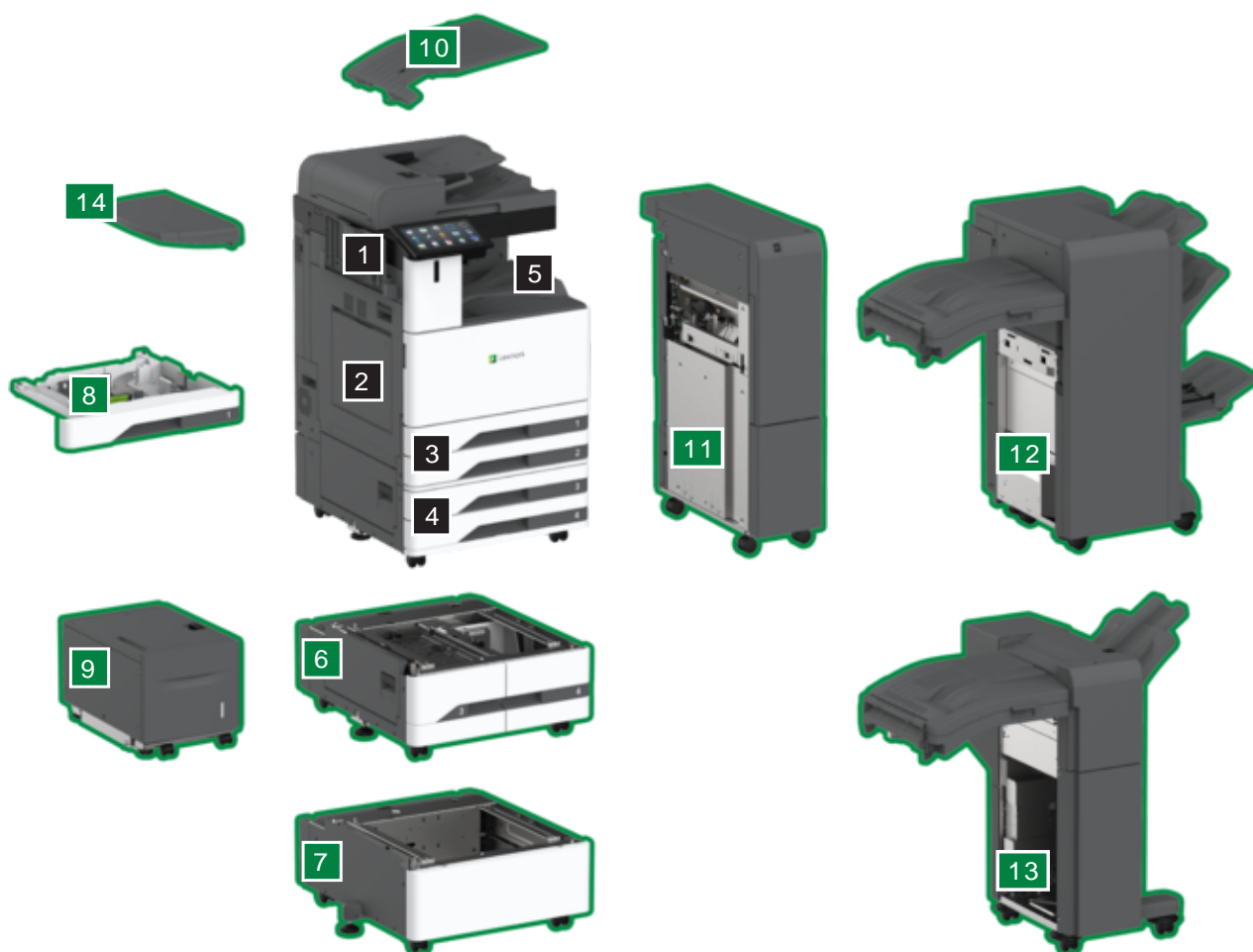

Callout	Availability	Description
1	Standard	
10	Optional	Dual Catch Bin
11	Optional	Tri-fold/Z-fold booklet finisher
12	Optional	Booklet staple hole punch finisher
13	Optional	Staple Punch Finisher
14	Optional	Work Table
2	Standard	100-Sheet Multipurpose Feeder
3	Standard	2 x 520-Sheet Tray
4	Standard	2 x 520-Sheet Tray with casters
5	Standard	400-Sheet Output Bin
6	Optional	2,000-Sheet Tandem Tray with casters
7	Optional	Caster Spacer
8	Optional	Envelope Tray
9	Optional	2,000-Sheet Tray (sidecar)

P/N	Toner Cartridges	P/N	Extended Warranties
83D0HC0	Lexmark CX942, 943, 944 Cyan 22K Toner Cartridge	2373502	CX944 3-Year Renewal Onsite Repair, Response Time Next Business Day
83D0HM0	Lexmark CX942, 943, 944 Magenta 22K Toner Cartridge	2373503	CX944 4-Year Renewal Onsite Repair, Response Time Next Business Day
83D0HY0	Lexmark CX942, 943, 944 Yellow 22K Toner Cartridge		
83D0HK0	Lexmark CX942, 943, 944 Black 45K Toner Cartridge	2373504	CX944 1-Year Post Warranty Onsite Repair Next Business Day
73D0P00	Lexmark CS943, CX942, 943, 944, XC9445, 55, 65 Black 165K Photoconductor	2373519	CX944 1-Year Parts Only Extended Warranty
73D0Q00	Lexmark CS943, CX942, 943, 944, XC9445, 55, 65 3-Pack 165K Photoconductor Kit	2373520	CX944 2-Year Parts Only Extended Warranty
73D0W00	Lexmark CS943, CX942, 943, 944, XC9445, 55, 65 35K Waste Container	2373521	CX944 3-Year Parts Only Extended Warranty
25A0013	Staple Cartridges (3 pack)	2373522	CX944 4-Year Parts Only Extended Warranty
		2373523	CX944 5-Year Parts Only Extended Warranty
		2373524	CX944 6-Year Parts Only Extended Warranty
P/N	Paper Handling		
32D0811	2 x 520-Sheet Tray with Casters	2373525	CX944 1-Year Renewal Parts Only
32D0812	2,000-Sheet Tandem Tray with Casters	2373526	CX944 2-Year Renewal Parts Only
32D0813	Envelope Tray	2373527	CX944 3-Year Renewal Parts Only
32D0816	2,000-Sheet Tray (sidecar)	2373528	CX944 4-Year Renewal Parts Only
32D0819	Dual Catch Bin		
32D0825	Booklet Staple (2/3) Hole Punch Finisher		
32D0826	Booklet Staple (2/4) Hole Punch Finisher		
32D0823	Staple (2/3) Hole Punch Finisher		
32D0824	Staple (2/4) Hole Punch Finisher		
32D0810	Caster Spacer		
32D0831	Tri-Fold/Z-Fold Booklet Finisher		
32D0815	Caster Cabinet		
P/N	Furniture		
32D0809	CX94x Work Table		
P/N	Memory Options		
27X0400	500+ GB Hard Disk		
57X0070	Removable Hard Disk Enclosure Kit		
P/N	Application Solutions		
57X0300	Contact Authentication Device		
57X0301	Contactless Authentication Device		
82S1204	Bar Code License		
82S1203	IPDS License		
P/N	Connectivity		
27X0142	Lexmark MarkNet™ N8230 Fiber Ethernet Print Server		
27X6410	Lexmark MarkNet N8372 802.11 a/b/g/n/ac Wireless Print Server		
57X7040	English Keyboard Kit		
1021294	USB (2 Meter) Cable		
14F0100	RS-232C Serial Interface Card		
SPD0002	Surge Protective Device, 220-240V		
P/N	Extended Warranties		
2373494	CX944 1-Year Onsite Repair NBD Warranty		
2373495	CX944 2-Year Onsite Repair NBD Warranty		
2373496	CX944 3-Year Onsite Repair NBD Warranty		
2373497	CX944 4-Year Onsite Repair NBD Warranty		
2373498	CX944 5-Year Onsite Repair NBD Warranty		
2373499	CX944 6-Year Onsite Repair NBD Warranty		
2373500	CX944 1-Year Renewal Onsite Repair, Response Time Next Business Day		
2373501	CX944 2-Year Renewal Onsite Repair, Response Time Next Business Day		