



Lexmark CX944adxse

The Lexmark CX944adxse large-format color multifunction is designed for security, versatility, and performance for large workgroups at speeds up to 65 pages per minute*.

Part Number

32D0500

Print Technology

Color Laser

Function

Color Copying, Color Faxing, Color Printing, Color Scanning, Color Network Scanning, Trusted Platform Module (TPM), The Trusted Platform Module (TPM) is not available in some countries.

Workgroup Size

Large Workgroup

Touch Screen Display

Yes

Display

Lexmark e-Task 10.1-inch (25.6 cm) color touch screen

Print Speed (Letter, Black)

Up to 65 ppm⁴

Print Speed (Letter, Color)

Up to 65 ppm⁴

Print Speed (Letter, Black) Duplex

Up to 65 spm⁴

Print Speed (Letter, Color) Duplex

Up to 65 spm⁴

Time to First Page (Black)

As fast as 4.7 seconds

Time to First Page (Color)

As fast as 5.2 seconds

Duplex (2-sided) Printing

Integrated Duplex

Print Resolution, Black

1200 x 1200 dpi, 2400 IQ (2400 x 600 dpi)

Print Resolution, Color

1200 x 1200 dpi, 2400 IQ (2400 x 600 dpi)

Copy Speed (Letter, Black)

Up to 65 cpm⁴

Copy Speed (Letter, Color)

Up to 65 cpm⁴

Copy Speed (Letter, Black) Duplex

Up to 65 spm⁴

Copy Speed (Letter, Color) Duplex

Up to 65 spm⁴

Time to First Copy (Black)

As fast as 6.6 seconds

Time to First Copy (Color)

As fast as 6.3 seconds

Reduce / Enlarge Range

25 - 400 %

A4/Ltr Simplex Scan Speed (Black)

Up to 73.5/72 sides per minute

A4/Ltr Simplex Scan Speed (Color)

Up to 73.5/72 sides per minute

A4/Ltr Duplex Scan Speed (Black)

Up to 146/144 sides per minute

A4/Ltr Duplex Scan Speed (Color)

Up to 146/144 sides per minute

Scan Area, Maximum

11.69 x 17.0 inches

ADF Scan

DADF (single pass Duplex)

Scanner Type

Flatbed scanner with automatic document feeder

Scan Resolution, Enhanced

Up to 600 x 600 dpi

Scan Resolution, Optical

Up to 600 dpi

Scan File Formats (Send as)

JPEG, JPG, PDF, Secure PDF, TIFF, Archival PDF (A-1a, A-1b), Searchable PDF

Scan Destinations

e-mail, FTP, USB Flash drive, USB or Network connected computer

Modem Speed

ITU T.30, V.34 Half-Duplex, 33.6 Kbps

Fax Transmission Speed

< 3 seconds per page

Processor Speed

Quad Core 1.2 GHz

Memory, Standard

4096 MB

Memory, Maximum

4096 MB

Hard Disk

Intelligent Storage Drive included; Magnetic Hard Disk (optional)

Apple Operating Systems Supported

Support is provided through AirPrint and AirScan only

Citrix MetaFrame

Microsoft Windows Server 2003 and 2003 X64 Edition with Citrix XenApp 5.0, Microsoft Windows Server 2008 and 2008 X64 Edition with Citrix XenApp 5.0, Microsoft Windows Server 2012 R2 Datacenter Edition running Citrix XenApp 7.5, 6, 7, 8, 9, 11, 12, 13, 14, 15, 16, Microsoft Windows Server 2012 Datacenter Edition running Citrix XenApp 7.5, 6, 7, 8, 9, 11, 12, 13, 14, 15, 16, Microsoft Windows Server 2012 Foundation running Citrix XenApp 6.0, 6.5, Microsoft Windows Server 2012 Essentials running Citrix XenApp 6.0, 6.5, Microsoft Windows Server 2012 Standard running Citrix XenApp 6.0, 6.5, Microsoft Windows Server 2008 R2 Datacenter Edition running Citrix XenApp 7.5, 6, 7, 8, 9, 11, 12, 13, 14, 15, 16, Microsoft Windows Server 2008 R2 Enterprise Edition running Citrix XenApp 6.0, 6.5, Microsoft Windows Server 2008 R2 Standard Edition running Citrix XenApp 6.0, 6.5

Linux Operating Systems Supported

openSUSE Linux 42.3, Fedora 27, 28, 29, Ubuntu 16.04, 18.04 LTS, Debian GNU/Linux 8.11, openSUSE Linux 15, Debian 9.4, Debian GNU/Linux 9.5, Debian GNU/Linux 9.6, Red Hat Linux 7.5, 7.6

Microsoft Windows Operating Systems Supported

Windows 2000, Windows NT (4.00/4.00 Server), Windows Me, Windows XP, Windows Server 2003, Windows 98 2nd Edition, Windows XP x64, Windows Server 2003 running Terminal Services, Windows 2000 Server running Terminal Services, Windows Server 2003 x64, Windows Server 2003 x64 running Terminal Services, Windows Vista, Windows Vista x64, Windows Server 2008, Windows Server 2008 x64, Windows Server 2008 running Terminal Services, Windows Server 2008 x64 running Terminal Services, Windows 7, Windows 7 x64, Windows Server 2008 R2, Windows Server 2008 R2 running Terminal Services, Windows 8, Windows 8 x64, Windows Server 2012, Windows 8.1, Windows 8.1 x64, Windows Server 2012 R2, Windows RT, Windows 10, Windows Server 2016, Windows Server 2019, Windows Server 2022, Windows 11

Novell Operating Systems Supported

Novell NetWare 6.5 Open Enterprise Server, Novell Open Enterprise Server 2 (SP3) on SuSE Linux Enterprise Server 10 SP4 (x86 and x64) 3, Novell Open Enterprise Server 11 (SP3) on SuSE Linux Enterprise Server 11 SP4 (x86 and x64), Novell Open Enterprise Server 11 (SP3) on SuSE Linux Enterprise Server 12 SP1 (x86 and x64), Novell Open Enterprise Server 15 (SP1) on SuSE Linux Enterprise Server 11 SP4 (x86 and x64)

Included Paper Handling

100-Sheet Multipurpose Feeder, 400-Sheet Output Bin, 2 x 520-Sheet Tray, 2000-Sheet Tandem Tray/Caster

Optional Paper Handling

Staple Punch Finisher, Inline Stapler, Envelope Tray, 2000-Sheet Tray, Dual Catch Bin, Work table, 2 x 520-Sheet Tray/Caster, Caster spacer, Tri-fold/Z-fold booklet finisher, Booklet staple hole punch finisher

Paper Input Capacity, Standard

Up to 3140 pages 20 lb or 75 gsm bond

Paper Input Capacity, Maximum

Up to 5140 pages 20 lb or 75 gsm bond

Paper Output Capacity, Standard

Up to 400 pages 20 lb or 75 gsm bond

Paper Output Capacity, Maximum

Up to 2000 pages 20 lb or 75 gsm bond

Paper Weight Range Supported - Standard Tray (lb.)

14 - 80 lb.

Paper Weight Range Supported - Multipurpose Feeder (lb.)

14 - 80 lb.

A3 / 11 x 17

Yes

ADF

130-Sheet Automatic Document Feeder

ADF Paper Input Capacity

Up to 130 pages 20 lb or 75 gsm bond

ADF Paper Output Capacity

Up to 130 pages 20 lb or 75 gsm bond

Finishing Option

Yes

Finishing Functions

Offset stacking, Stapling, Hole punching, Booklet fold and saddle stapling

Number of Paper Inputs, Standard

5

Number of Paper Inputs, Maximum

6

Media Types Supported

Card Stock, Envelopes, Glossy Paper, Labels, Plain Paper, Refer to the Paper & Specialty Media Guide

Media Sizes Supported

10 Envelope, 7 3/4 Envelope, 9 Envelope, A3, A4, A5, B5 Envelope, C4 Envelope, C5 Envelope, DL Envelope, B5, Hagaki Card, Executive, Folio, JIS-B4, JIS-B5, Ledger, Legal, Letter, Statement, Oficio, A6, SRA3

Standard Ports

One Internal Card Slot, USB 2.0 Specification Hi-Speed Certified (Type B), Gigabit Ethernet (10/100/1000), Rear USB 2.0 Specification Hi-Speed Certified Port (Type A), Front Hi-Speed USB Port Compatible with USB 2.0 Specification (Type A)

Optional Local Ports

Internal RS-232C serial

Optional Network Ports

MarkNet N8230 Fiber Ethernet Print Server, Marknet N8372 WiFi Option

Direct USB

Yes

Ethernet Network

Yes

Network Protocol Support

TCP, UDP, IPSEC w/ IPv4, IPSEC w/ IPv6, ICMP, IGMP, IPv4, IPv6

Network Printing Methods

Enhanced IP (Port 9400), IPP 1.0, 1.1, 2.0 (Internet Printing Protocol), Microsoft Web Services WSD, Pull Printing

Network Management Protocols

WINS, APIPA (AutoIP), DHCP, DNS, DDNS, mDNS, ARP, BOOTP

Network Security

SNMPv3, 802.1x Authentication: MD5, MSCHAPv2, LEAP, PEAP, TLS, TTLS, Certificate Management, SSL Cipher Configuration, TCP/UDP Port Access Control, Security Port Lockdown, TCP Restricted Server List, IPSEC Support (IPv4/IPv6)

Printable Area

0.17 inches of the top, bottom, right and left edges (within)

Printer Languages (Standard)

PCL 6 Emulation, Personal Printer Data Stream (PPDS), PostScript 3 Emulation, Direct Image, PDF 1.7 emulation, PCL 5, PCLm

Fonts and Symbol Sets

158 scalable PostScript fonts, 39 scalable PPDS fonts, 5 PPDS bitmap fonts, For more information, refer to the Technical Reference., 89 scalable PCL 5/6 fonts, 2 PCL 5/6 bitmap fonts

Laser Cartridge Yields (up to)³

22,000-page Color (CMY) Cartridges, , 45,000-page Black Cartridge

Photoconductor Estimated Yield, Black

Up to 165,000 pages, based on 5 average letter/ A4-size pages per print job

Photoconductor Estimated Yield, CMY

Up to 165,000 pages, based on 5 average letter/ A4-size pages per print job

Cartridge(s) Shipping with Product

18,500-page Black Toner Cartridge, 11,500-page Color (CMY) Toner Cartridges

Replacement Cartridges:

Product functions only with replacement cartridges designed for use in a specific geographical region. See www.lexmark.com/ regions for more details.

Packaged Size (in. - H x W x D)

52.2 x 29.6 x 33.4 in.

Packaged Weight (lb.)

360 lb.

Size (in. - H x W x D)

44.9 x 24.4 x 29.7 in.

Weight (lb.)

306.5 lb.

Noise Level, Idle

29 dBA

Noise Level (Print), Operating

52 dBA

Duplex Print Noise Level, Operating

52 dBA

Noise Level (Copy), Operating

57 dBA

Noise Level (Scan), Operating

56 dBA

ENERGY STAR

Yes

Average Power (Hibernate Mode)

0.1 watts

Average Power (Sleep Mode)

1.2 watts

Average Power (Ready Mode)

88 watts

Average Power (Printing)

840 watts

ENERGY STAR Typical Electricity Consumption (TEC)

1 kilowatt-hours per week

Limited Warranty - See Statement of Limited Warranty

1-Year Onsite Repair, Next Business Day

Product Certifications

ENERGY STAR, ICES-003 Class A, BSMI Class A, VCCI Class A, FCC Class A, NOM-032, UL, cUL, NOM, US FDA/CDRH, IEC 60825-1, CB Report, ISO-532B, CE (EU) DoC, EFTA (CE), KC logo, CCC, C-tick DoC, EuP, CECF, CEL, EC 1275/2008, ECMA-370, TED, SII, TER, SABS, UL-AR, GS Mark, Green Dot, ISO-9296, COC, CCD-035 EcoLogo, Green Mark, EPEAT, China Green Product (CGP), Mopria Certified

Maximum Monthly Duty Cycle

Up to 340 000 pages per month²

Recommended Monthly Page Volume

7000 - 50000 pages¹

Specified Operating Environment

Humidity: 8 to 80% Relative Humidity, Altitude: 0 - 2500 Meters (8,200 Feet), Temperature: 10 to 32°C (50 to 90°F)

Country of Origin

North America & TAA Compliant - Mexico, Rest of World - Vietnam

UNSPSC Code

43212110

Harmonized Tariff Code

8443.31.0000

¹"Recommended Monthly Page Volume" is a range of pages that helps customers evaluate Lexmark's product offerings based on the average number of pages customers plan to print on the device each month. Lexmark recommends that the number of pages per month be within the stated range for optimum device performance, based on factors including: supplies replacement intervals, paper loading intervals, speed, and typical customer usage.

²"Maximum Monthly Duty Cycle" is defined as the maximum number of pages a device could deliver in a month using a multishift operation. This metric provides a comparison of robustness in relation to other Lexmark printers and MFPs.

³Average continuous black or continuous composite CMY declared cartridge yield up to this number of standard pages in accordance with ISO/IEC 19798.

⁴Print and copy speeds measured in accordance with ISO/IEC 24734 and ISO/IEC 24735 respectively (ESAT). For more information see: www.lexmark.com/ISOspeeds.

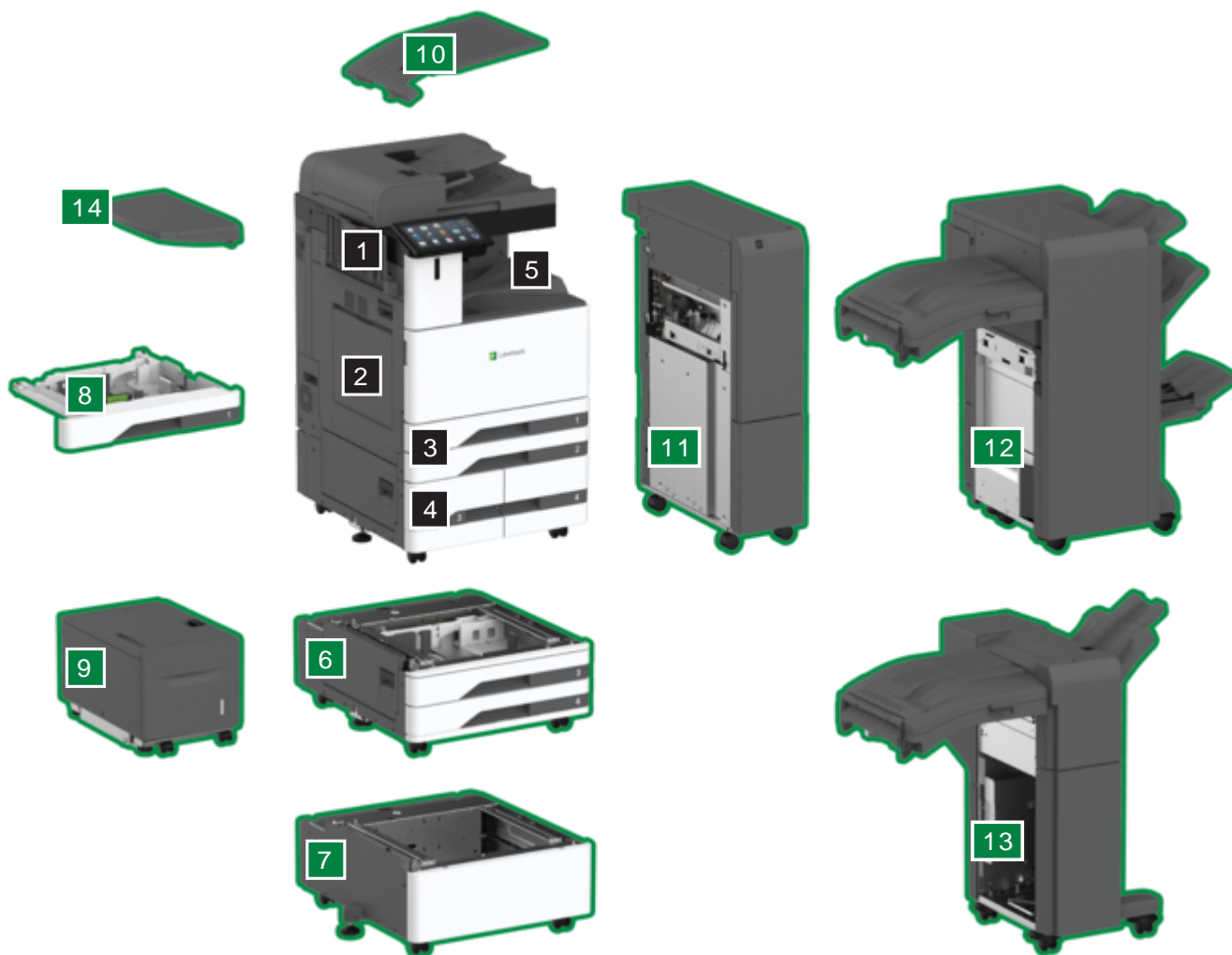

Callout	Availability	Description
1	Standard	Dual Catch Bin
10	Optional	Dual Catch Bin
11	Optional	Tri-fold/Z-fold booklet finisher
12	Optional	Booklet staple hole punch finisher
13	Optional	Staple Punch Finisher
14	Optional	Work Table
2	Standard	100-Sheet Multipurpose Feeder
3	Standard	2 x 520-Sheet Tray
4	Standard	2,000-Sheet Tandem Tray with casters
5	Standard	400-Sheet Output Bin
6	Optional	2 x 520-Sheet Tray with casters
7	Optional	Caster Spacer
8	Optional	Envelope Tray
9	Optional	2,000-Sheet Tray (sidecar)

P/N Toner Cartridges		P/N Extended Warranties	
83D0HC0	Lexmark CX942, 943, 944 Cyan 22K Toner Cartridge	2373499	CX944 6-Year Onsite Repair NBD Warranty
83D0HM0	Lexmark CX942, 943, 944 Magenta 22K Toner Cartridge	2373500	CX944 1-Year Renewal Onsite Repair, Response Time Next Business Day
83D0HY0	Lexmark CX942, 943, 944 Yellow 22K Toner Cartridge	2373501	CX944 2-Year Renewal Onsite Repair, Response Time Next Business Day
83D0HK0	Lexmark CX942, 943, 944 Black 45K Toner Cartridge	2373502	CX944 3-Year Renewal Onsite Repair, Response Time Next Business Day
73D0P00	Lexmark CS943, CX942, 943, 944, XC9445, 55, 65 Black 165K Photoconductor	2373503	CX944 4-Year Renewal Onsite Repair, Response Time Next Business Day
73D0Q00	Lexmark CS943, CX942, 943, 944, XC9445, 55, 65 3-Pack 165K Photoconductor Kit	2373504	CX944 1-Year Post Warranty Onsite Repair Next Business Day
73D0W00	Lexmark CS943, CX942, 943, 944, XC9445, 55, 65 35K Waste Container	2373505	CX944 Per Call On Site Repair NBD Warranty
25A0013	Lexmark 3-Pack 15K Finisher Staples	2373519	CX944 1-Year Parts Only Extended Warranty
P/N Paper Handling		2373520	CX944 2-Year Parts Only Extended Warranty
32D0811	2 x 520-Sheet Tray	2373521	CX944 3-Year Parts Only Extended Warranty
32D0812	2000-Sheet Tandem Tray with Caster	2373522	CX944 4-Year Parts Only Extended Warranty
32D0813	Envelope Tray	2373523	CX944 5-Year Parts Only Extended Warranty
32D0816	2000-Sheet Tray (sidecar)	2373524	CX944 6-Year Parts Only Extended Warranty
32D0819	Dual Catch Bin	2373525	CX944 1-Year Renewal Parts Only
32D0825	1500-Sheet Booklet Staple 2/3 Hole Punch Finisher	2373526	CX944 2-Year Renewal Parts Only
32D0826	1500-Sheet Booklet Staple 2/4 Hole Punch Finisher	2373527	CX944 3-Year Renewal Parts Only
32D0823	2000-Sheet Staple 2/3 Hole Punch Finisher	2373528	CX944 4-Year Renewal Parts Only
32D0824	2000-Sheet Staple 2/4 Hole Punch Finisher	2373549	CX944 Per Call Preventive Maintenance w/ Kit
32D0810	Caster Spacer		
32D0830	Z-fold Trifold option for Booklet Finisher		
32D0815	Caster Cabinet		
P/N Furniture			
32D0809	CX94x Work Table		
P/N Memory Options			
27X0400	500+ GB Hard Disk		
57X0070	Removable Hard Disk Enclosure Kit		
P/N Application Solutions			
57X0300	Contact Authentication Device		
57X0301	Contactless Authentication Device		
82S1204	Bar Code License		
82S1203	IPDS License		
P/N Connectivity			
27X0142	Lexmark MarkNet™ N8230 Fiber Ethernet Print Server		
27X6410	Lexmark MarkNet N8372 802.11 a/b/g/n/ac Wireless Print Server		
57X7040	English Keyboard Kit		
1021294	USB Cable (2-meter)		
14F0100	RS-232C Serial Interface Card		
SPD0001	Surge Protective Device, 110-120V		
P/N Extended Warranties			
2373494	CX944 1-Year Onsite Repair NBD Warranty		
2373495	CX944 2-Year Onsite Repair NBD Warranty		
2373496	CX944 3-Year Onsite Repair NBD Warranty		
2373497	CX944 4-Year Onsite Repair NBD Warranty		
2373498	CX944 5-Year Onsite Repair NBD Warranty		