

Disassembly of Waste Electrical and Electronic Equipment (WEEE) Manual

EU Waste Electronic and Electrical Equipment Directive require producers to provide information of the different electronic and electrical materials and components found in their products at its end-of-life, and disassembly references to treatment and recycling facilities.

1. Product information
2. Materials and components list for selective treatment
3. Disassembly tools
4. Disassembly references

The following information is intended only for the use of recognized treatment and recycling facilities.

Section 1: Product information

Model name(s)— The product models are grouped together in series and are mechanically equivalent.

Lexmark CS42x Series

C2325dw, CS421dn, C2425dw

Lexmark CS52x Series

CS521dn, C2535dw

Lexmark CS62x Series

CS622de, C2240

Section 2: Materials and components list for selective treatment

Table 2: Materials and components list for selective treatment

Description	Count	Notes
Polychlorinated biphenyls (PCB) containing capacitors	0	N/A
Mercury containing components, such as switches or backlighting lamps	0	N/A
Batteries	1	***** <u>Total Count = 1</u> ***** Lithium Manganese Oxide coin cell located on the Controller card
Printed circuit boards greater than 10 cm ²	multiple	***** <u>Minimum Count = 12</u> For details, see Annex B ***** <u>Options:</u> 1 – 550/ 650 Sheet Tray 1 – HDD (CS622) *****
Toner cartridges, liquid and pasty, as well as colour toner	9	4 – Toner cartridge 4 – Imaging unit 1 – Waste toner bottle
<u>Plastic component(s)</u> that may contain BFR (brominated [§] flame retardants)	multiple	***** <u>Minimum Count = 19</u> For details, See Annex A ***** <u>Options:</u> <u>+2</u> – for each 550/ 650 Paper handling *****
Note (§) - This product may contain plastic parts with brominated flame retardants. Recycler should treat these parts separately. See section 4.3 Disclaimer.		
Asbestos waste and components which contain asbestos	0	N/A
Cathode ray tubes	0	N/A
Chlorofluorocarbons (CFC), Hydrochlorofluorocarbons (HCFC) or Hydrofluorocarbons (HFC), Hydrocarbons (HC)	0	N/A
Gas discharge lamps	0	N/A
Liquid Crystal Display (LCD) greater than <u>100 cm²</u> and those back-lighted with Gas discharge lamps	0	N/A
External electrical cables	1	Power cord located on the back lower left quadrant
Components containing refractory fibres	0	N/A
Components containing radioactive substances	0	N/A
Electrolyte capacitors containing substances of concern (<i>capacitors with height > 25 mm, diameter > 25 mm or proportionately similar volume</i>)	1	Capacitor located on Power Supply
Electrical and Electronic (EE) Customer Replaceable Paper handling devices	multiple	See Customer Replaceable Paper handling devices For details, See Annex C
Electrical and Electronic (EE) Customer Replaceable Internal/External Card options	multiple	See External Card options For details, See Annex D

Section 3: Common Tools for Disassembly

Table 3.1 - Disassembly tools

Item	Description
1	#2 Phillips screwdriver, magnetic
2	Wire cutter
3	E-clip puller or small flat-head screwdriver
4	Standard slotted head screwdriver





Section 4: Disassembly references

4.1 Removal procedure(s)

WEEE materials and components removal procedures are available upon request.

Please Contact: recycling@lexmark.com

4.2 Graphical illustration of material's and component's location

-  LCD > 100 cm²
-  PCBs > 10 cm²
-  Printer components containing Brominated flame retardants
-  Battery

4.3 Disclaimer

Statement on WEEE Bromine Levels

Manufacturer is compliant with the European Directive 2012/19/EU and European Commission's mandated technical specification CLC/TS 50625-3-1:2015 stating that plastic containing brominated flame retardants (BFR) must be removed from any separately collected WEEE (Article 8, Annex VII) if total bromine concentration in the fraction is known to be >2000 ppm, or expected to be >2000 ppm, or if it is not declared. Concentrations of bromine <2000 ppm are acceptable for reuse and do not require separation, so that the re-use and recycling of components or whole appliances is not hindered per Annex II, Section 3 of the WEEE Directive (2002/96/EU), and Annex VII, Section 3 of the WEEE Directive (2012/19/EU).

Section 5: Supplies

- LCD > 100 cm²
- PCBs > 10 cm²
- Printer components containing Brominated flame retardants
- Battery



Figure 5.1: Toner Cartridge

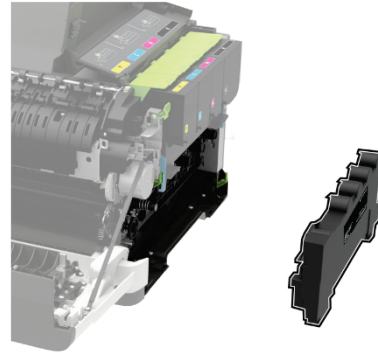

Figure 5.2: Waste toner bottle

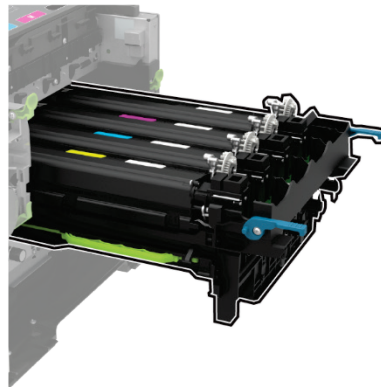

Figure 5.3: Imaging Unit

Table 5: Supplies – Printed Circuit Boards >10cm² and Plastic with Brominated flame retardants

Item	Description
--	None

Table Component Count (*without options*)

LCD>100cm ²	= 0
PCBs>10cm ²	= 0
BFR Plastics	= 0
Battery	= 0

Section 6: Control Panel

- LCD > 100 cm²
- PCBs > 10 cm²
- Printer components containing Brominated flame retardants
- Battery

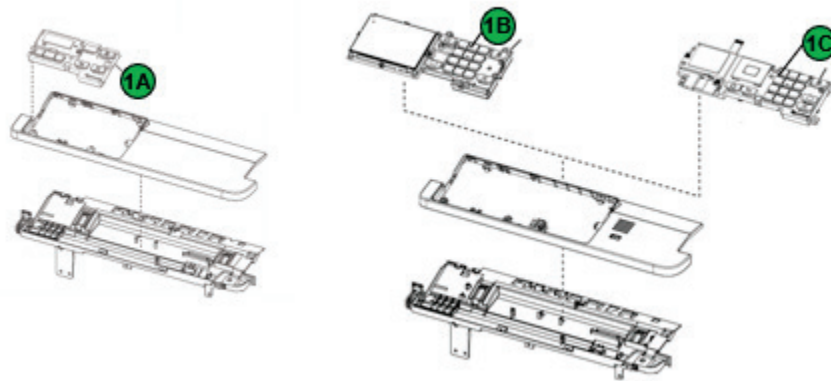

Figure 6.1: Control Panel

Table 6: Control Panel - Printed Circuit Boards >10cm² and Plastic with Brominated flame retardants

Item	Description
1A	2-line control panel assembly
1B	4.3-inch control panel assembly
1C	2.4-inch control panel assembly
Table Component Count (without options)	
LCD>100cm ² = 0	
PCBs>10cm ² = 1	
BFR Plastics = 0	
Battery = 0	

Section 7: Covers

- LCD > 100 cm²
- PCBs > 10 cm²
- Printer components containing Brominated flame retardants
- Battery

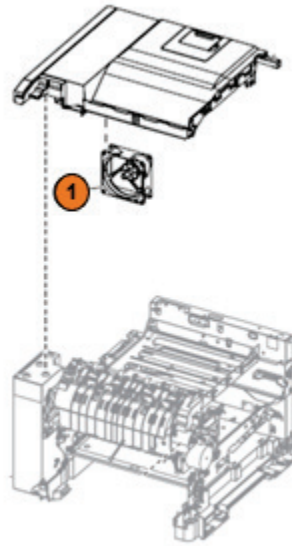

Figure 7.1: Covers

Table 7: Covers- Printed Circuit Boards >10cm² and Plastic with Brominated flame retardants

Item	Description
1	System Fan
Table Component Count (without options)	
LCD>100cm ² = 0	
PCBs>10cm ² = 0	
BFR Plastics = 1	
Battery = 0	

Section 8: Paper path and frame

- LCD > 100 cm²
- PCBs > 10 cm²
- Printer components containing Brominated flame retardants
- Battery

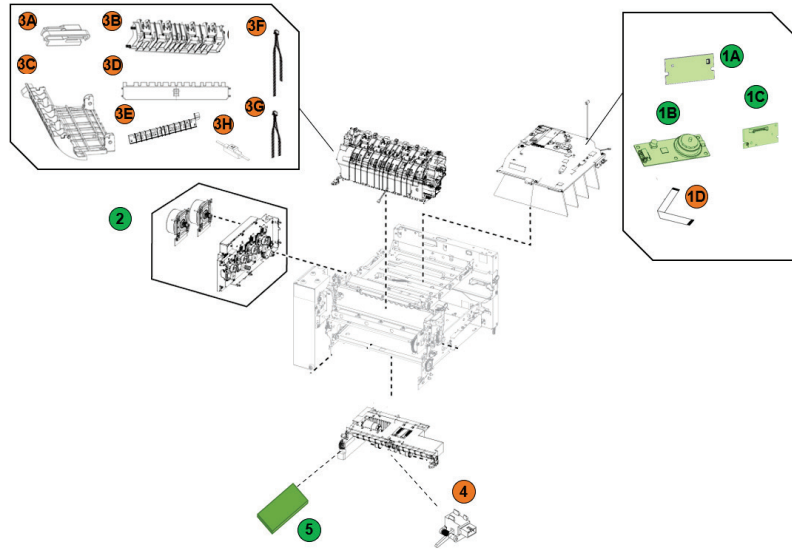

Figure 8.1: Paper path and frame

Table 8: Paper path and frame - Printed Circuit Boards >10cm² and Plastic with Brominated flame retardants

Item	Description
1A	Printhead hsync PCBA
1B	Printhead Laser driver PCBA
1C	Printhead Polygon PCBA
1D	Printhead Tape
2	EP Drive motors 2x
3A	HOUSING-HEATER AC CONNECTOR
3B	GUIDE - INNER EXIT
3C	GUIDE - DUPLEX
3D	GUIDE - ENTRY
3E	GUIDE - OUTER EXIT
3F	Sensor (Photo)
3G	Sensor (Thermistor)
3H	Sensor (Thermistor)
4	Sensor (Staging)
5	Paper path PCBA

Table Component Count (without options)

LCD>100cm² = 0
 PCBs>10cm² = 6
 BFR Plastics = 10
 Battery = 0

Section 9: Electronics

- LCD > 100 cm²
- PCBs > 10 cm²
- Printer components containing Brominated flame retardants
- Battery

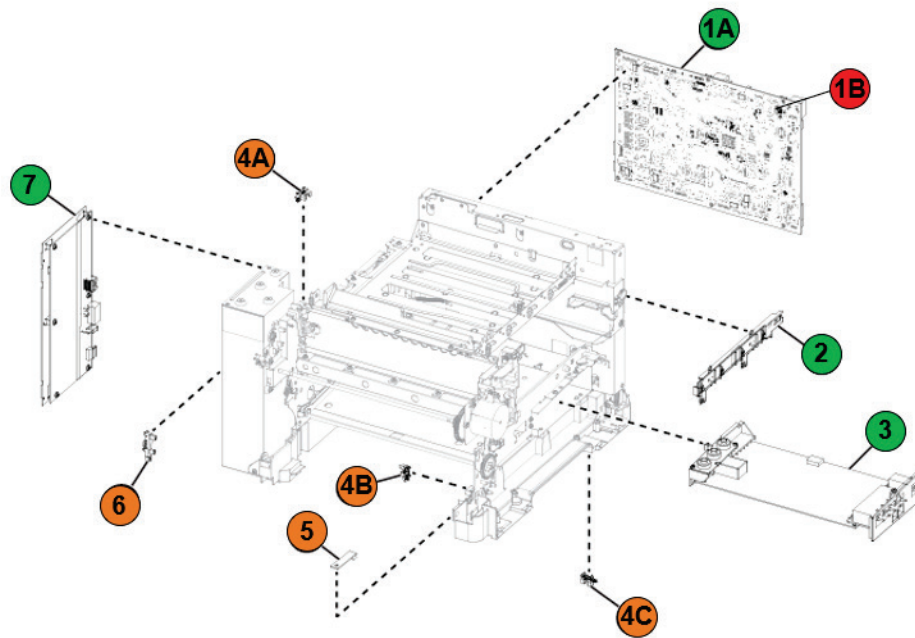

Figure 9.1: Electronics

Table 9: Electronics - Printed Circuit Boards >10cm² and Plastic with Brominated flame retardants

Item	Description
1A	Controller board
1B	Battery
2	Toner meter card
3	High voltage power supply
4A	Sensor (tray present)
4B	Sensor (duplex)
4C	Sensor (narrow media/bin full)
5	Weather station
6	Sensor (fuser exit)
7	low-voltage power supply

Table Component Count (without options)

LCD>100cm² = 0
 PCBs>10cm² = 4
 BFR Plastics = 5
 Battery = 1

Section 10: Cables and sensors

- LCD > 100 cm²
- PCBs > 10 cm²
- Printer components containing Brominated flame retardants
- Battery

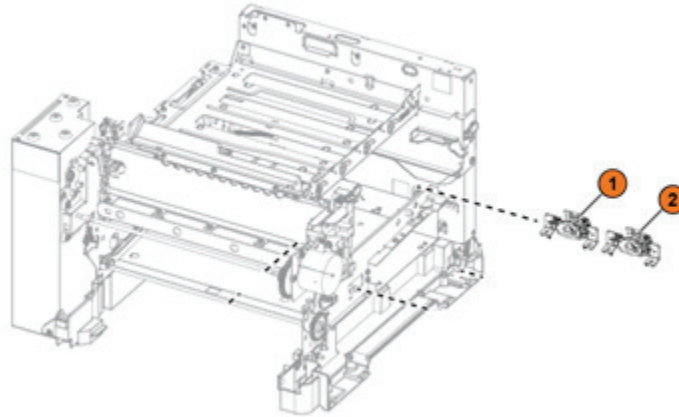

Figure 10.1: Cables and sensor

Table 10: Cables and sensor - Printed Circuit Boards >10cm² and Plastic with Brominated flame retardants

Item	Description
1	Sensor (left toner patch with thermistor)
2	Sensor (right toner patch with thermistor)

Table Component Count (*without options*)

LCD>100cm² = 0
 PCBs>10cm² = 0
 BFR Plastics = 2
 Battery = 0

Section 11: For Reference Only (Customer Replaceable Paper handling devices)

- LCD > 100 cm²
- PCBs > 10 cm²
- Printer components containing Brominated flame retardants
- Battery



Figure 11.1: Customer Replaceable Paper Handling Devices

Table 11: For Reference Only (Customer Replaceable Paper Handling Devices)

Item	Description
1	650-sheet duo tray
2	550-sheet tray
3	Adjustable printer stand*
4	Swivel cabinet*

Options marked with (*) are non-Electrical and electronic units

Section 12: 550/650 Handling Options

- LCD > 100 cm²
- PCBs > 10 cm²
- Printer components containing Brominated flame retardants
- Battery

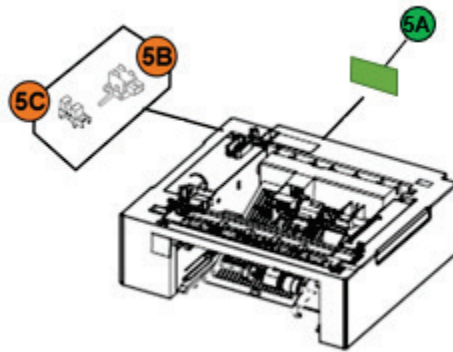
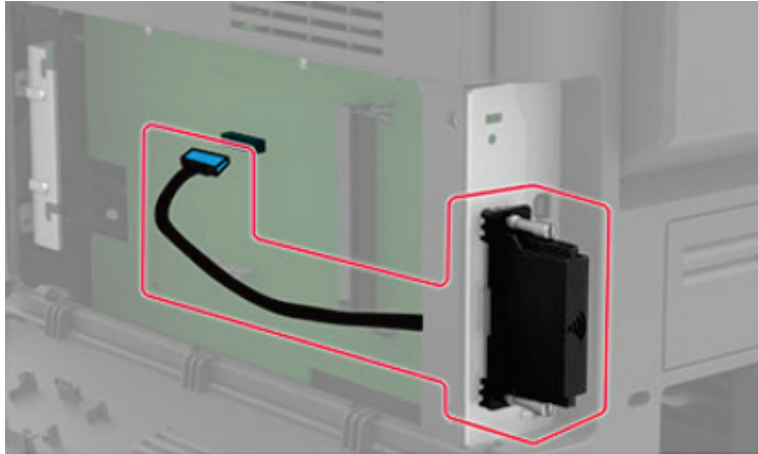

Figure 12.1: 550/650 Paper Handling Options

Table 12: 250/550 Paper Handling Options - Printed Circuit Boards >10cm² and Plastic with Brominated flame retardants

Item	Description
5A	PHO card
5B	Sensor – Staging within the assembly
5C	Sensor – PHOTOINTERRUPTER within the assembly
Table Component Count (without options)	
LCD>100cm ²	= 0
PCBs>10cm ²	= 1
BFR Plastics	= 2
Battery	= 0

Section 13: For Reference Only (Customer Replaceable External Card Options)



External Print Servers²

Note 1: Illustration shows actual options and their typical locations and mounting at the front side of the printer. However, this does not show the actual printer model.

Note 2: Illustration shows actual options and their typical locations and mounting at the rear side of the printer. However, this does not show the actual printer model.

Annex A – Printer components with Brominated^S Flame Retardants

Item	Description	Parts Marking	Qty	CS42x	CS52X	CS62x	Location
1	System fan	N/A	1	X	X	X	Covers
2	HOUSING-HEATER AC CONNECTOR	PBT-GF15 FR(17)	1	X	X	X	Paper path and frame
3	GUIDE - INNER EXIT	PET-(GF+MD)40 FR(17)	1	X	X	X	Paper path and frame
4	GUIDE - DUPLEX	PET-(GF+MD)40 FR(17)	1	X	X	X	Paper path and frame
5	GUIDE - ENTRY	PET-(GF+MD)40 FR(17)	1	X	X	X	Paper path and frame
6	GUIDE – OUTER EXIT	PET-(GF+MD)40 FR(17)	1	X	X	X	Paper path and frame
7	Printhead tape	N/A	1	X	X	X	Paper path and frame
8	Sensor (Photo)	N/A	1	X	X	X	Paper path and frame
9	Sensor (Thermistor)	N/A	1	X	X	X	Paper path and frame
10	Sensor (Thermistor)	N/A	1	X	X	X	Paper path and frame
11	Sensor (Staging)	N/A	1	X	X	X	Paper path and frame
12	Sensor (tray present)	N/A	1	X	X	X	Electronics
13	Sensor (duplex)	N/A	1	X	X	X	Electronics
14	Sensor (narrow media/bin full)	N/A	2	X	X	X	Electronics
15	Sensor (fuser exit)	N/A	1	X	X	X	Electronics
16	Weather station	N/A	1	X	X	X	Electronics
17	Sensor (left toner patch with thermistor)	N/A	1	X	X	X	Cables and sensors
18	Sensor (right toner patch with thermistor)	N/A	1	X	X	X	Cables and sensors
19	Sensor – Staging	N/A	1	Optional	Optional	Optional	550/ 650 option tray
20	Sensor – PHOTOINTERRUPT ER	N/A	1	Optional	Optional	Optional	550/ 650 option tray
Minimum Count (without options) =			19				

Annex B – Printed Circuit Boards >10cm²

Item	Description	Qty	CS42x	CS52X	CS62x	Location
1A	2-line control panel assembly	1	X			Control panel
1B	4.3-inch control panel assembly	1			X	Control panel
1C	2.4-inch control panel assembly	1		X		Control panel
2	Printhead motor driver PCBA	1	X	X	X	Paper path and frame
3	Printhead Motor PCBA	1	X	X	X	Paper path and frame
4	Printhead Laser driver PCBA	1	X	X	X	Paper path and frame
5	Printhead Laser driver PCBA	1	X	X	X	Paper path and frame
6	Paper path PCBA	1	X	X	X	Paper path and frame
7	EP drive assembly with motor PCB	2	X	X	X	Paper path and frame
8	Controller board	1	X	X	X	Electronics
9	Toner meter card	1	X	X	X	Electronics
10	High voltage power supply	1	X	X	X	Electronics
11	110 W low-voltage power supply	1	X	X	X	Electronics
12	550 or 650 PHO card	1	Optional	Optional	Optional	550/650 Handling Options
Minimum Count (without options) =		12				Note: Total does not include optional accessories

Annex C – Electrical and Electronic (EE) Customer Replaceable Paper handling devices

Item	PN	Description	CS42x Series CS52x Series CS62x Series	Locations
1	42C7650	650-sheet duo tray	X	Paper handling devices
2	42C7550	550-sheet tray		

Annex D – Electrical and Electronic (EE) Customer Replaceable Internal/ External Card Options

Item	PN	Description	CS42x	CS52X	CS62x	Locations
1	57X9801	Memory options	X	X	X	Attached to Controller board
2	57X0185	Security card			X	
3	40C9200 40C9202	Firmware cards (Forms and Bar code, Prescribe, IPDS)	X	X	X	
4	57X9810 57X9812 57X9814 57X9815	Font cards	X	X	X	
5	27X0800 27X0801 27X0812	Interface cards			X	External option
6	27X6410	Wireless	X	X	X	
7	27X0805	500 GB USB hard disk drive with backpack kit (CS622 and C2240 only)			X	